

RETAIL SPACE

15 CLIFF STREET

Between Fulton and John Streets

FIDI

MANHATTAN | NY

941 SF

For Lease



SPACE DETAILS

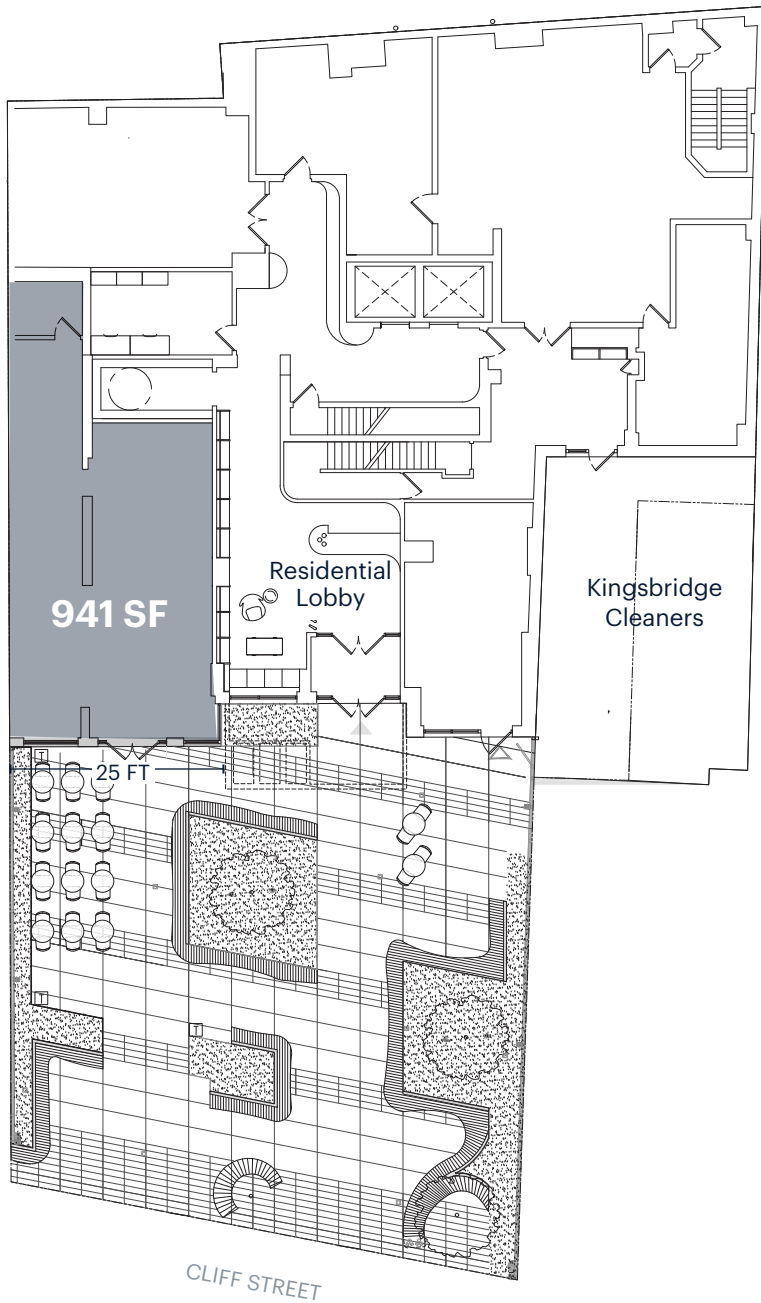

LOCATION

Between Fulton and John Streets

SIZE

Ground Floor 941 SF

FRONTAGE

Cliff Street 25 FT

CEILING HEIGHT

Ground Floor 12 FT

STATUS

Currently Hole in the Wall

POSSESSION

September 2026

RENT

Upon request

NEIGHBORS

Stout NYC, Felice 15 Gold, Sweat 440 Fitness, Paris Baguette, 55 Fulton Market, and Orangetheory Fitness

COMMENTS

Vented restaurant space
Seating on an outdoor public plaza area
Base of a 156-unit luxury apartment building

TRANSPORTATION

2024 Ridership Report

Fulton Street	A	C	J	Z	2	3	4	5
Annual	19,221,396							
Weekday	61,190							
Weekend	66,029							

AREA RETAIL



CONTACT EXCLUSIVE AGENTS

ANDREW MANDELL
 amandell@ripcony.com | 212.750.0705

SAM MARTORELLA
 smartorella@ripcony.com | 212.230.5882

AMELIA KAPLAN
 akaplan@ripcony.com | 646.827.7736

RIPCO | 150 East 58th Street
 REAL ESTATE | 15th Floor
 New York, NY 10115
 212.750.6565

Please visit us at ripcony.com for more information

This information has been secured from sources we believe to be reliable, but we make no representations as to the accuracy of the information. References to square footage are approximate. Buyer must verify the information and bears all risk for any inaccuracies.