



**1,800 SF**

For Lease

**RESTAURANT FORMER SPACE/  
RESTAURANT PERMITTED SPACE**

# **154 WEST 13TH STREET**

South side of West 13th Street between 6th and 7th Avenues

**GREENWICH VILLAGE**  
MANHATTAN | NY

**RIPCO**  
REAL ESTATE

# SPACE DETAILS

## GROUND FLOOR

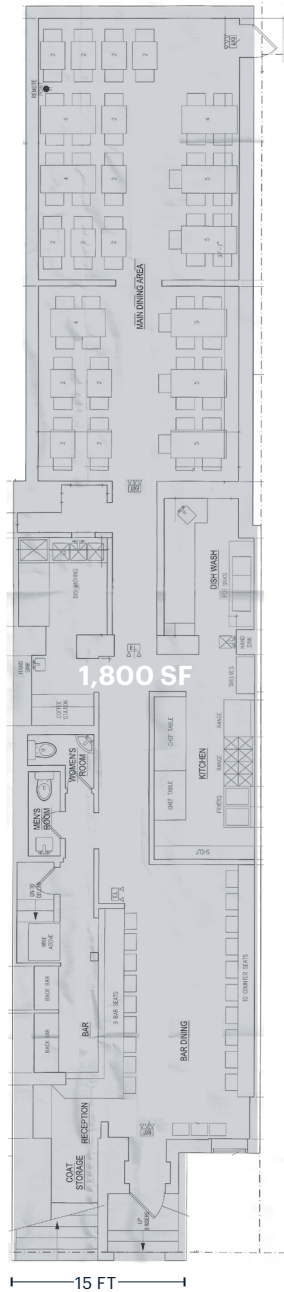

WEST 13TH STREET

### LOCATION

South side of West 13th Street  
between 6th and 7th Avenues

### SIZE

Ground Floor 1,800 SF  
Lower Level 1,000 SF

### FRONTAGE

West 13th Street 15 FT

### CEILING HEIGHTS

Ground Floor 10 FT

### STATUS

Vacant

### POSSESSION

Immediate

### TERM

10 years

### RENT

~\$15,000 per month

### CO-TENANTS

Sotto 13

### NEIGHBORS

Lenox Health Greenwich Village,  
Dental House, Birch Coffee,  
and Elm Wellness

### COMMENTS

Business for sale/assignment

Key Money upon request

Free rent available for  
qualified assignee

JV partnership will be considered

### TRANSPORTATION

2023 Ridership Report

**14 Street Station** ① ② ③  
Annual 11,328,347  
Weekday 34,811  
Weekend 45,938

**14th Street and 7th Avenue** ④ ⑤  
Annual 4,465,036  
Weekday 13,626  
Weekend 18,536

## ADDITIONAL PHOTOS



**CONTACT  
EXCLUSIVE  
AGENT**

**ERIC FISHER**  
efisher@ripcony.com  
718.233.6565



**RIPCO**  
REAL ESTATE

32 Court Street  
10th Floor  
Brooklyn, NY 11201  
718.233.6565

**Please visit us at [ripcony.com](http://ripcony.com) for more information**

This information has been secured from sources we believe to be reliable, but we make no representations as to the accuracy of the information. References to square footage are approximate. Tenant or Buyer must verify the information and bears all risk for any inaccuracies.