

STREET RETAIL/POP-UP/MEDICAL/FOOD AND BEVERAGE (NON-VENTED)

187 KENT AVENUE

Southeast corner of N 3rd Street

WILLIAMSBURG

BROOKLYN | NEW YORK

**2,200 -
12,000 SF**

For Lease



RIPCO
REAL ESTATE

SPACE DETAILS

GROUND FLOOR

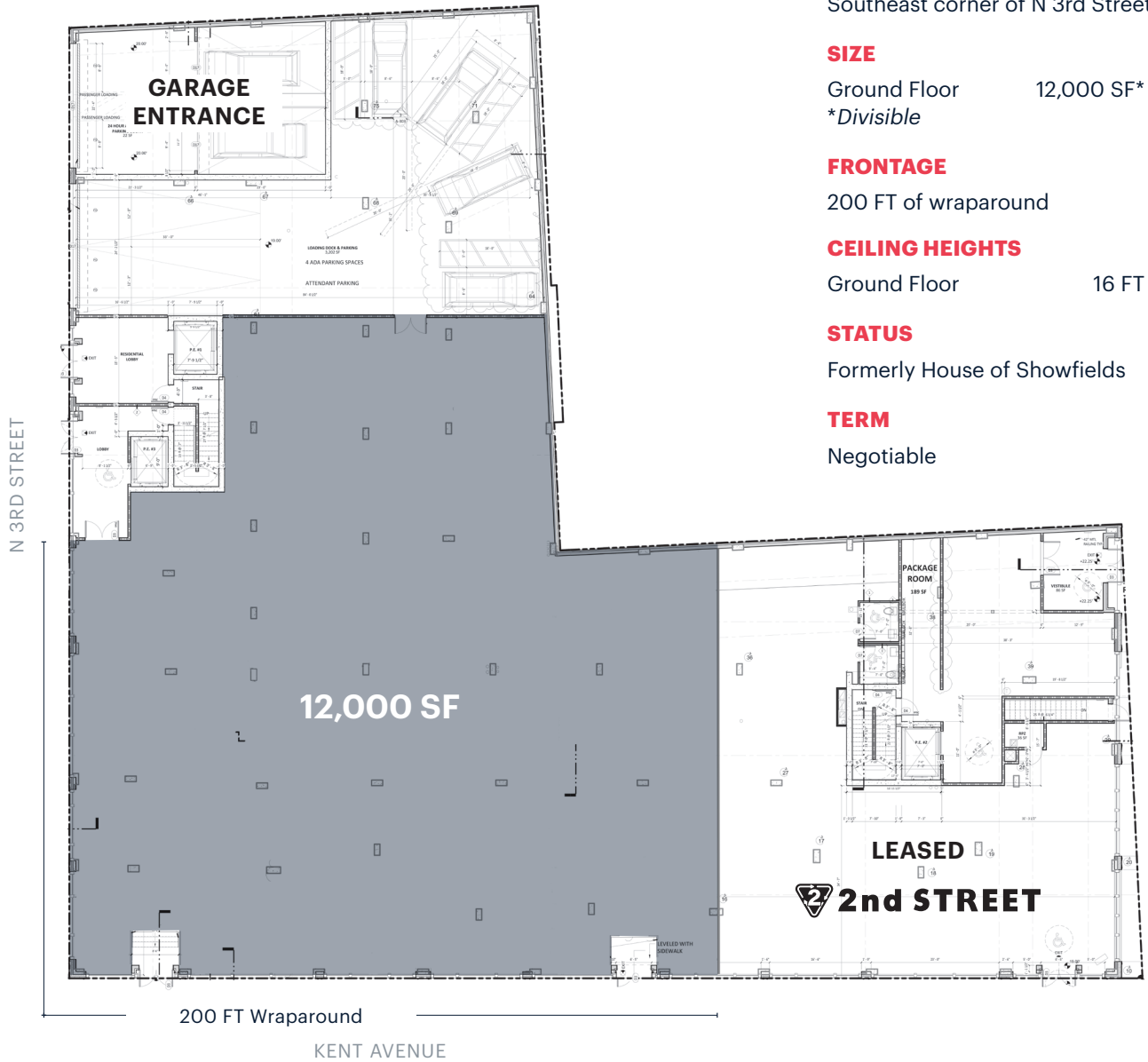

LOCATION

Southeast corner of N 3rd Street

SIZE

Ground Floor 12,000 SF*
*Divisible

FRONTAGE

200 FT of wraparound

CEILING HEIGHTS

Ground Floor 16 FT

STATUS

Formerly House of Showfields

TERM

Negotiable

RENT

Upon request

NEIGHBORS

2nd Street Clothing (coming soon), Trader Joe's, J. Crew, Vans, The Wythe Hotel, Brooklyn Bowl, Artists and Fleas, Brooklyn Brewery, The Williamsburg Hotel, CVS pharmacy, Music Hall of Williamsburg, Rough Trade, Everlane, Pure Barre, Soul Cycle, and Muji

COMMENTS

Ground Floor can be divided into a two tenant scenario
Lower Level is leased to Action Black Gym
Second Floor Garage available for lease

TRANSPORTATION

2023 Ridership Report

Bedford Avenue	
Annual	8,399,477
Weekday	23,653
Weekend	44,011

East River Ferry	
Daily	19,713
Ridership approximately 6.1 Million in 2022	

PROPOSED DIVISIONS - TWO TENANT SCENARIO

GROUND FLOOR

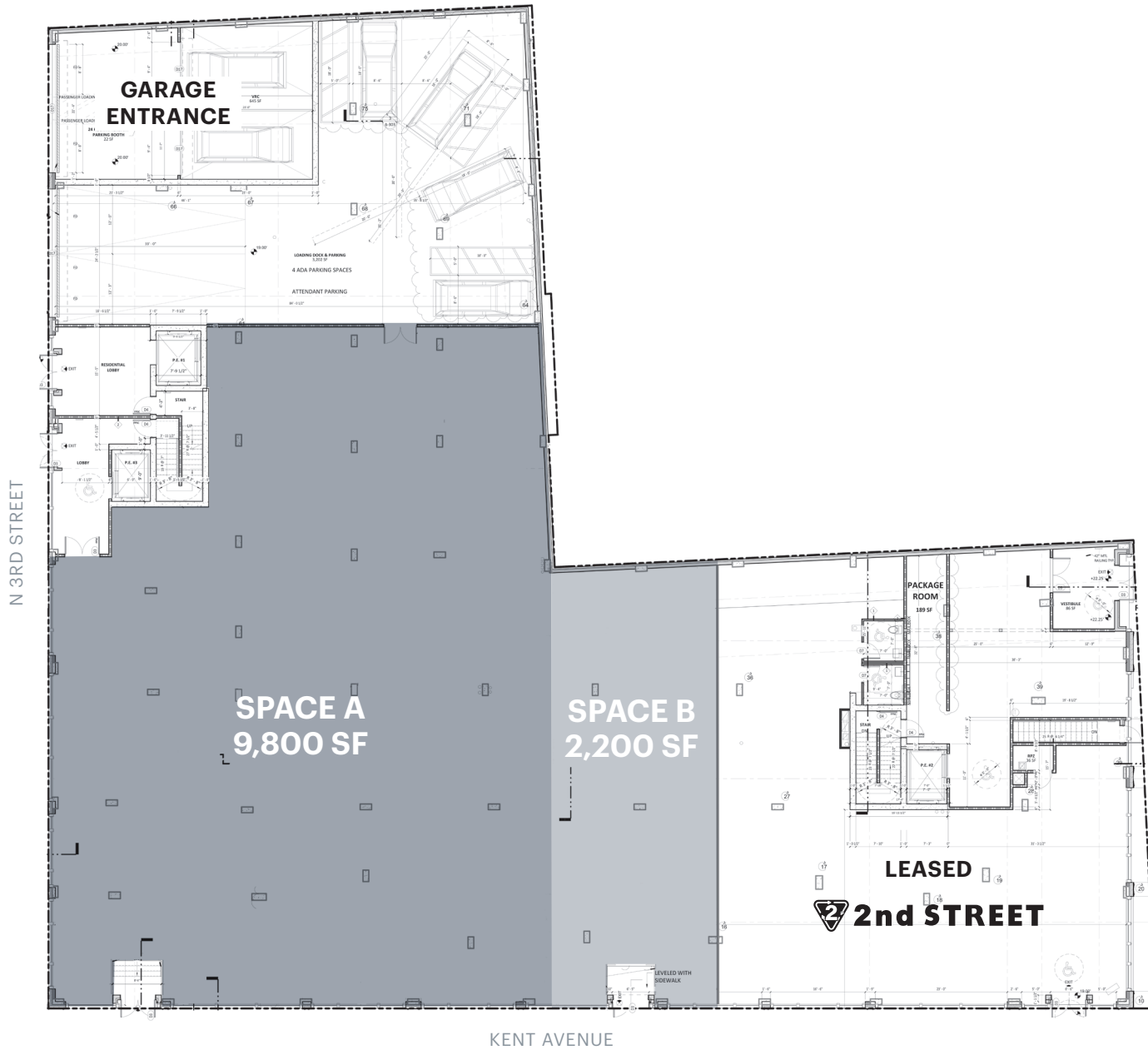

AREA RETAIL



187 KENT AVENUE

CONTACT EXCLUSIVE AGENTS

ALEX BEARD
 abeard@ripcony.com | 718.663.2640

ESTELLE HOLM PEDERSEN
 epedersen@ripcony.com | 718.633.2641

BRENDAN REICHENBACHER
 ber@ripcony.com | 973.902.2436

RIPCO
 REAL ESTATE
 32 Court Street
 10th Floor
 Brooklyn, NY 11201
 718.233.6565

Please visit us at ripcony.com for more information

This information has been secured from sources we believe to be reliable, but we make no representations as to the accuracy of the information. References to square footage are approximate. Buyer must verify the information and bears all risk for any inaccuracies.