

**FULLY EQUIPPED SECOND GENERATION RESTAURANT TURN-KEY OPPORTUNITY  
AVAILABLE FOR KEY-MONEY - ASKING PRICE UPON REQUEST**

# 515 WASHINGTON STREET

Between 5th and 6th Streets

**HOBOKEN**  
NEW JERSEY

**880 SF +  
500 SF  
basement**

For Lease



# SPACE DETAILS

## GROUND FLOOR

WASHINGTON STREET

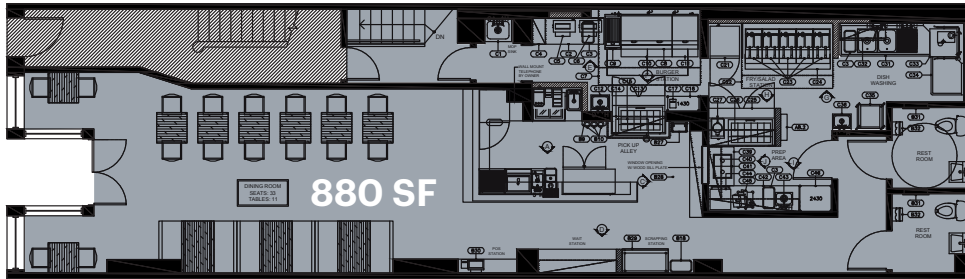

### LOCATION

Between 5th and 6th Streets

### SIZE

Ground Floor 880 SF

Basement 500 SF

### STATUS

Currently **Bareburger** ORGANIC

### REMAINING TERM

Upon request

### RENT

Upon request

### KEY-MONEY

Upon request

### POSSESSION

Arranged

### FRONTAGE

16 FT 5 IN on Washington Street

### CEILING HEIGHTS

9 FT 4 IN

### NEIGHBORS

O'Bagel, Gong Cha, East LA, Muteki Ramen, Brooklyn Dumpling Shop, Framebridge, Paper Source

### COMMENTS

Prime location in Hoboken

Turn-key second generation restaurant

Fully vented with gas

Walk-in box and storage in lower level

Key-money upon request

Potential for new long-term deal

Outdoor seating available

*\*Please be discreet. Tenant is still open and operating. Do not approach employees.*

## BASEMENT

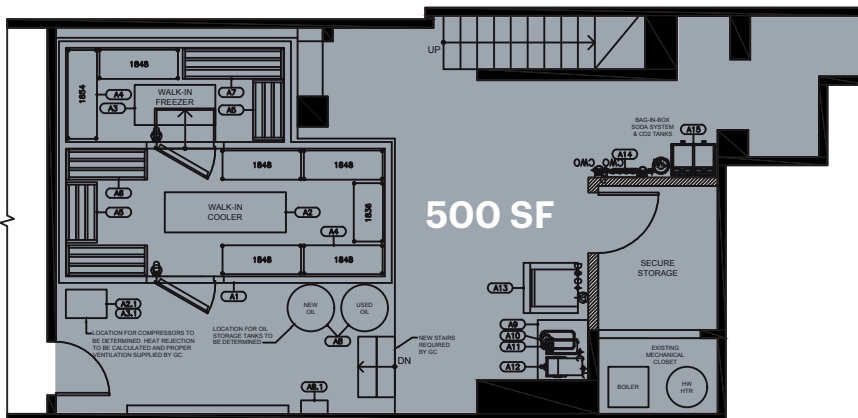

# INTERIOR PHOTOS



# AREA RETAIL

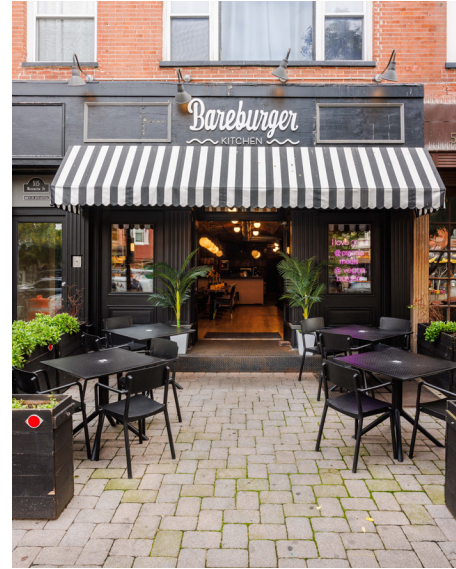
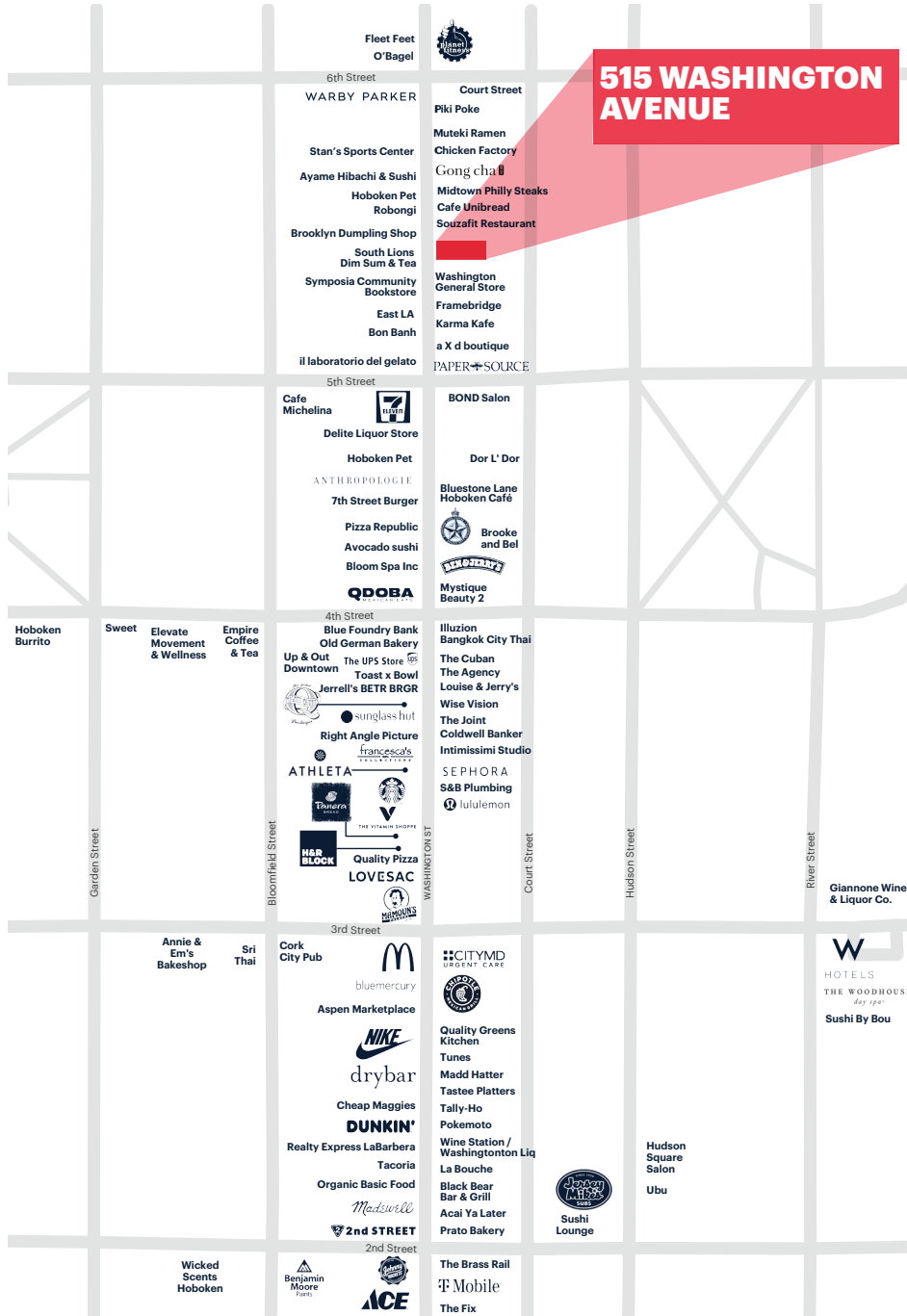

## CONTACT EXCLUSIVE AGENTS

**DILLON ROSS**  
 dross@ripcony.com  
 646.827.7738

**JON PAUL PIRRAGLIA**  
 jppirraglia@ripcony.com  
 646.827.7735

**RIPCO**  
 REAL ESTATE

150 East 58th Street  
 15th Floor  
 New York, NY 10115  
 212.750.6565

**Please visit us at ripcony.com for more information**

This information has been secured from sources we believe to be reliable, but we make no representations as to the accuracy of the information. References to square footage are approximate. Buyer must verify the information and bears all risk for any inaccuracies.