



650 SF
Ground Floor + Mezzanine
For Lease

STREET RETAIL

383 SECOND AVENUE

Between East 22nd and 23rd Streets

GRAMERCY PARK
MANHATTAN | NEW YORK

RIPCO
REAL ESTATE

SPACE DETAILS

LOCATION

Between East 22nd and 23rd Street

SIZE

Ground Floor	460 SF
Mezzanine	190 SF
Total	650 SF

FRONTAGE

Second Avenue	14 FT
---------------	-------

CEILING HEIGHTS

Ground Floor	15 FT
Mezzanine	15 FT

STATUS

Formerly Boyar Gifts

POSSESSION

Immediate

RENT

\$4,200 per month

TERM

Long term

NEIGHBORS

Club Pilates, Prohealth Pharmacy, Morton Williams, Kumon, UPS, Malii Thai, and Small Door

COMMENTS

Boutique space in beautiful art-deco building

Quality non-food uses are considered

No dispensaries

TRANSPORTATION

2022 Ridership Report

23rd Street	6
Annual	4,766,220
Weekday	15,952
Weekend	13,133
2nd Ave/E. 23rd	15
Annual	9,628,034
Weekday	30,009
Weekend	36,823



GROUND FLOOR PLANS AND INTERIOR PHOTOS

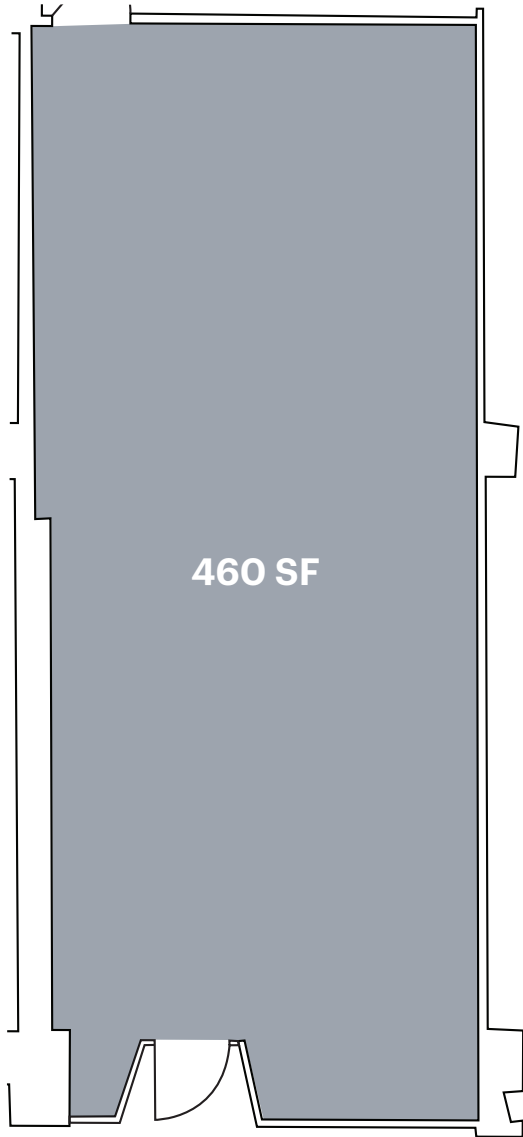

14 FT

SECOND AVENUE



AREA RETAIL

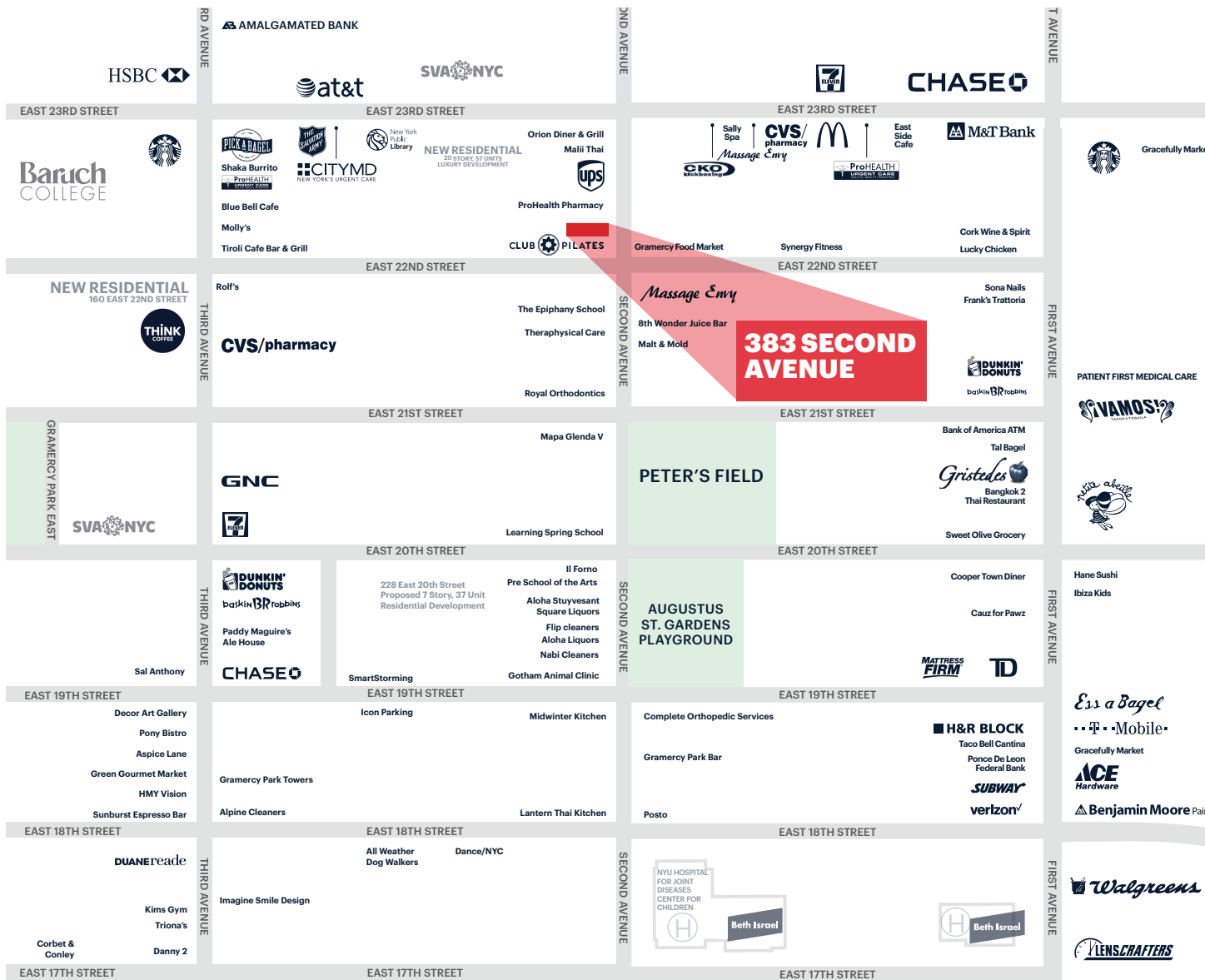

CONTACT EXCLUSIVE AGENT

JASON PENNINGTON
 jpennington@ripcony.com
 212.750.6565

Coming Soon



150 East 58th Street
 15th Floor
 New York, NY 10115
 212.750.6565

Please visit us at ripcony.com for more information

This information has been secured from sources we believe to be reliable, but we make no representations as to the accuracy of the information. References to square footage are approximate. Tenant or Buyer must verify the information and bears all risk for any inaccuracies.