

RETAIL SPACE

35 BEDFORD STREET

Between Downing and Carmine Streets

WEST VILLAGE
MANHATTAN | NY

684 SF

For Lease



SPACE DETAILS

GROUND FLOOR

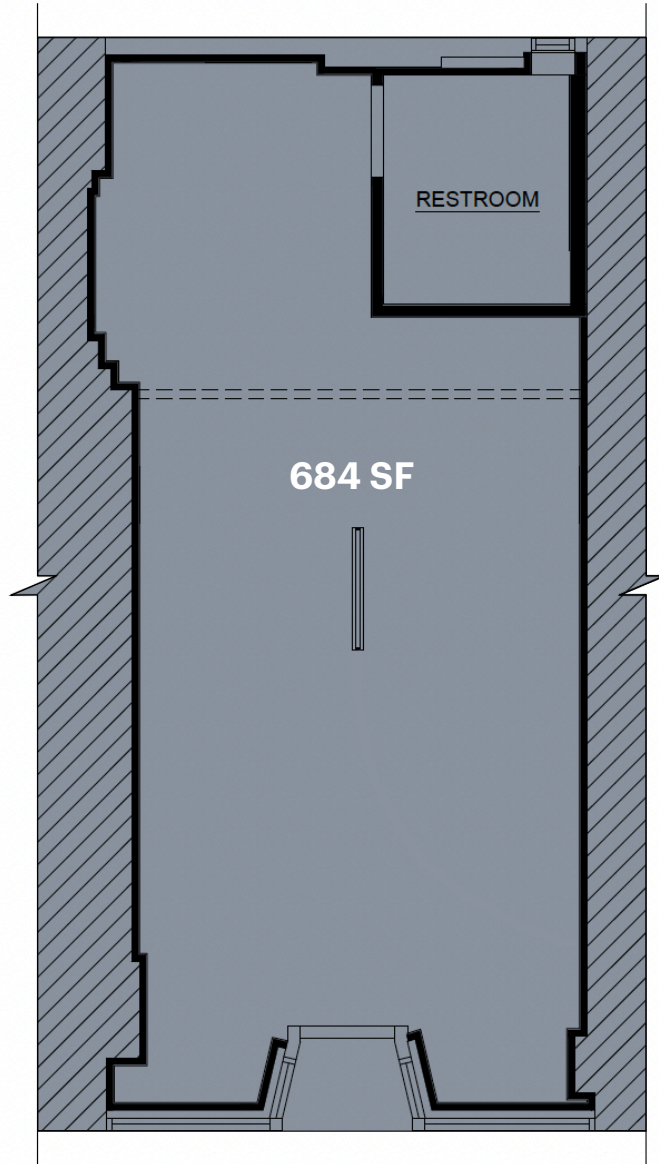

18 FT
BEDFORD STREET

LOCATION

West side of Bedford Street
between Downing and Carmine
Streets

SIZE

Ground Floor 684 SF

FRONTAGE

Bedford Street 18 FT

CEILING HEIGHTS

Ground Floor 10 FT

STATUS

Formerly Psychic

RENT

Upon request

NEIGHBORS

Jack's Wife Freda
Jajaja Mexicana
Nami Nori
Emily West Village
Daily Provisions
Sveta
Market Table
The Grey Dog West Village

COMMENTS

Landlord is in the process of white-
boxing the space

Boutique space in the heart of the
West Village

TRANSPORTATION

2022 Ridership Report

Houston Street 1
Annual 2,374,723
Weekday 7,630
Weekend 8,055

W 4 St - Wash Sq A C E
B D F M
Annual 2,729,596
Weekday 23,733
Weekend 39,222

AREA RETAIL



CONTACT EXCLUSIVE AGENTS

RICHARD SKULNIK

rskulnik@ripcony.com | 212.750.0756

LINDSAY ZEGANS

lzegans@ripcony.com | 646.827.9962

BEN SABIN

bsabin@ripcony.com | 646.290.2018

MARY SCHWAGERL

mschwagerl@ripcony.com | 212.230.5887

RIPCO
REAL ESTATE

150 East 58th Street
15th Floor
New York, NY 10115
212.750.6565

Please visit us at ripcony.com for more information

This information has been secured from sources we believe to be reliable, but we make no representations as to the accuracy of the information. References to square footage are approximate. Buyer must verify the information and bears all risk for any inaccuracies.