

RETAIL SPACE

57 TRINITY PLACE

Southeast corner of Trinity Place and Rector Street

FINANCIAL DISTRICT

NEW YORK | NY

1,300 SF

Retail Space
For Lease



RIPCO
REAL ESTATE

SPACE DETAILS

GROUND FLOOR

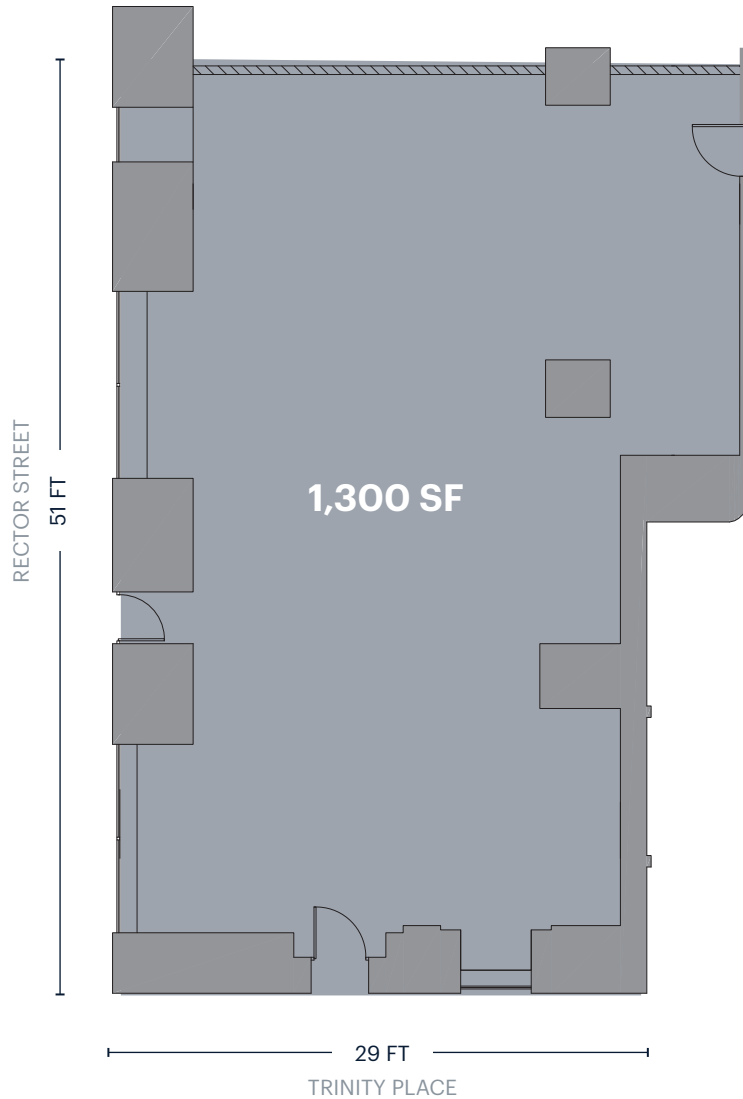

LOCATION

Southeast corner of Rector Street and Trinity Place

SIZE

Ground Floor 1,300 SF

FRONTAGE

Rector Street 51 FT

Trinity Place 29 FT

CEILING HEIGHTS

Ground Floor 12 FT

TERM

Long-term

RENT

Upon request

NEIGHBORS

Trinity Church, World Trade Center, The W Hotel, New York Stock Exchange, Century 21, Joseph A. Bank, Starbucks, Bills Burger Bar & Grill, Cipriani, John Allen, Equinox, Duane Reade, TD Ameritrade, Whole Foods, Lifetime Fitness

COMMENTS

Join Biscuits & Bath and European Wax Center

Close proximity to the new One Wall Street Condominium with 566 luxury condos, Whole Foods, and Lifetime Fitness at the base

All uses considered

TRANSPORTATION

2022 Ridership Report

Rector Street	R W
Annual	952,233
Weekday	3,117
Weekend	2,916

Wall Street	4 5
Annual	2,729,596
Weekday	9,027
Weekend	7,965

AREA RETAIL



CONTACT EXCLUSIVE AGENTS

ANDREW MANDELL
 amandell@ripcony.com
 646.827.9963

SAM MARTORELLA
 smartorella@ripcony.com
 212.230.5882

RIPCO | 150 East 58th Street
 REAL ESTATE | 15th Floor
 New York, NY 10155
 212.750.6565

Please visit us at ripcony.com for more information

This information has been secured from sources we believe to be reliable, but we make no representations as to the accuracy of the information. References to square footage are approximate. Buyer must verify the information and bears all risk for any inaccuracies.