

RETAIL/RESTAURANT/MEDICAL/FITNESS/COMMUNITY FACILITY/QSR

# 175 KENT AVENUE

Between North 3rd and North 4th Streets

**WILLIAMSBURG**

BROOKLYN | NY

**2,434 SF**  
Available for Lease



**RIPCO**  
REAL ESTATE

# SPACE DETAILS

## GROUND FLOOR

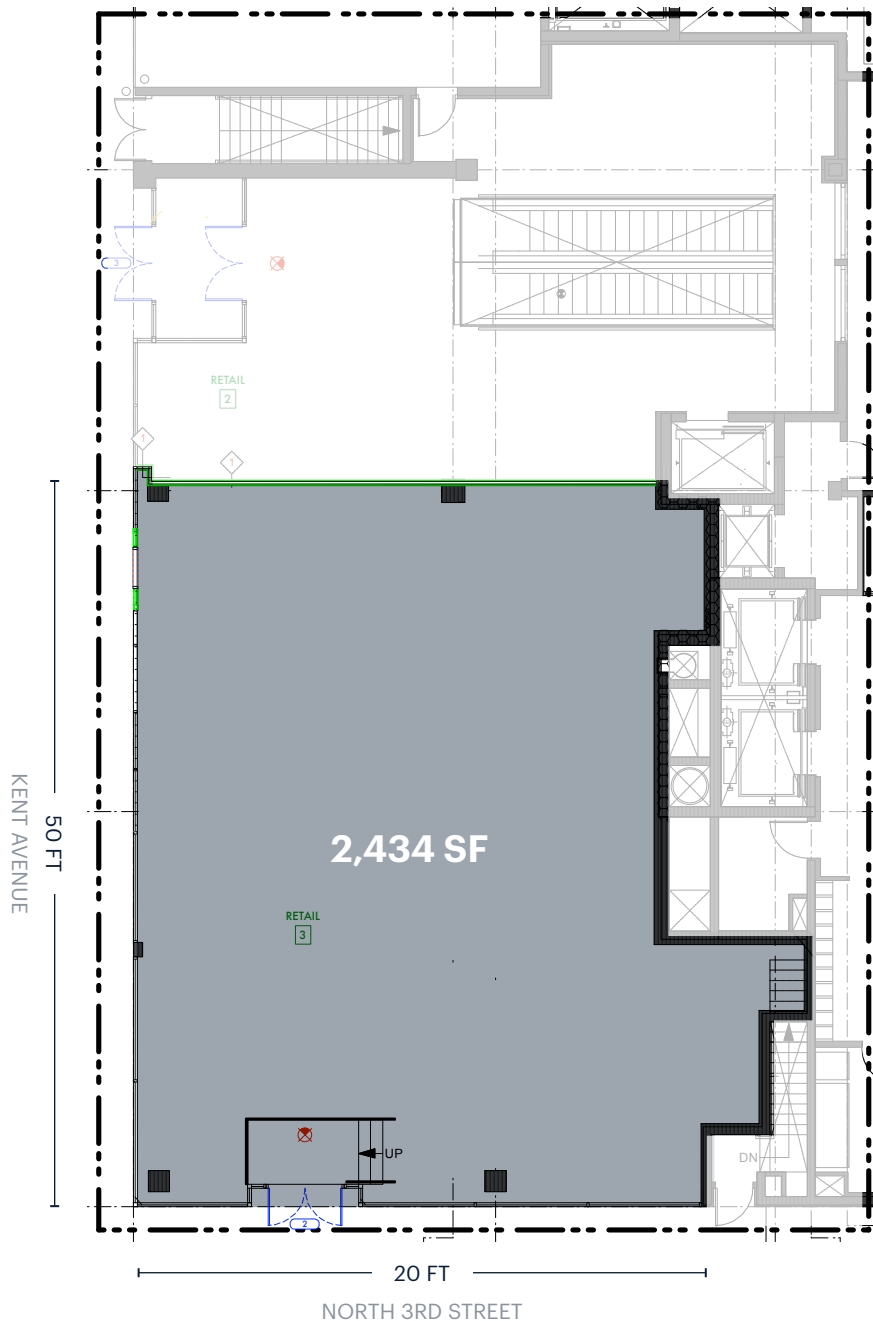

### LOCATION

North side of North 3rd Street  
between Kent and Wythe Avenues

### SIZE

Ground Floor 2,434 SF  
Basement Storage 300 SF

### FRONTAGE

Kent Avenue 50 FT  
North 3rd Street 20 FT

### CEILING HEIGHTS

Ground Floor Approx. 14 FT

### ASKING RENT

Upon Request

### STATUS

Formerly Sobol and Krispy Krust

### POSSESSION

Immediate

### TRANSPORTATION

2023 Ridership Report

**Bedford Avenue**   
Annual 8,399,477  
Weekday 23,653  
Weekend 44,011

### NEIGHBORS

Trader Joe's, Smorgasburg, Artists and Fleas, The Wythe Hotel, The Williamsburg Hotel, J. Crew, Brooklyn Bowl, Brooklyn Brewery, Williamsburg Music Hall, CVS, Brooklyn Harvest, PQ Coffee, Music Hall of Williamsburg, Rough Trade, Vans, Everlane, Pure Barre, Soul Cycle, Marine Layer, and Muji

### COMMENTS

Across the street from Trader Joe's Williamsburg store  
Clean former ice cream shop space  
Walk in freezer in place and in good condition

**East River Ferry**   
Daily 11,903  
Ridership approximately  
6.1 Million in 2022

# AREA RETAIL



## CONTACT EXCLUSIVE AGENTS

**BEN WEINER**

bweiner@ripcony.com | 718.233.6565

**BRENDAN REICHENBACHER**

ber@ripcony.com | 973.902.2436

**RIPCO**  
REAL ESTATE

32 Court Street  
10th Floor  
Brooklyn, NY 11201  
718.233.6565

Please visit us at [ripcony.com](http://ripcony.com) for more information

This information has been secured from sources we believe to be reliable, but we make no representations as to the accuracy of the information. References to square footage are approximate. Buyer must verify the information and bears all risk for any inaccuracies.