

RETAIL/RESTAURANT/MEDICAL/FITNESS/COMMUNITY FACILITY/QSR

175 KENT AVENUE

Between North 3rd and North 4th Streets

WILLIAMSBURG

BROOKLYN | NY

2,750 SF
Available for Lease



RIPCO
REAL ESTATE

SPACE DETAILS

GROUND FLOOR

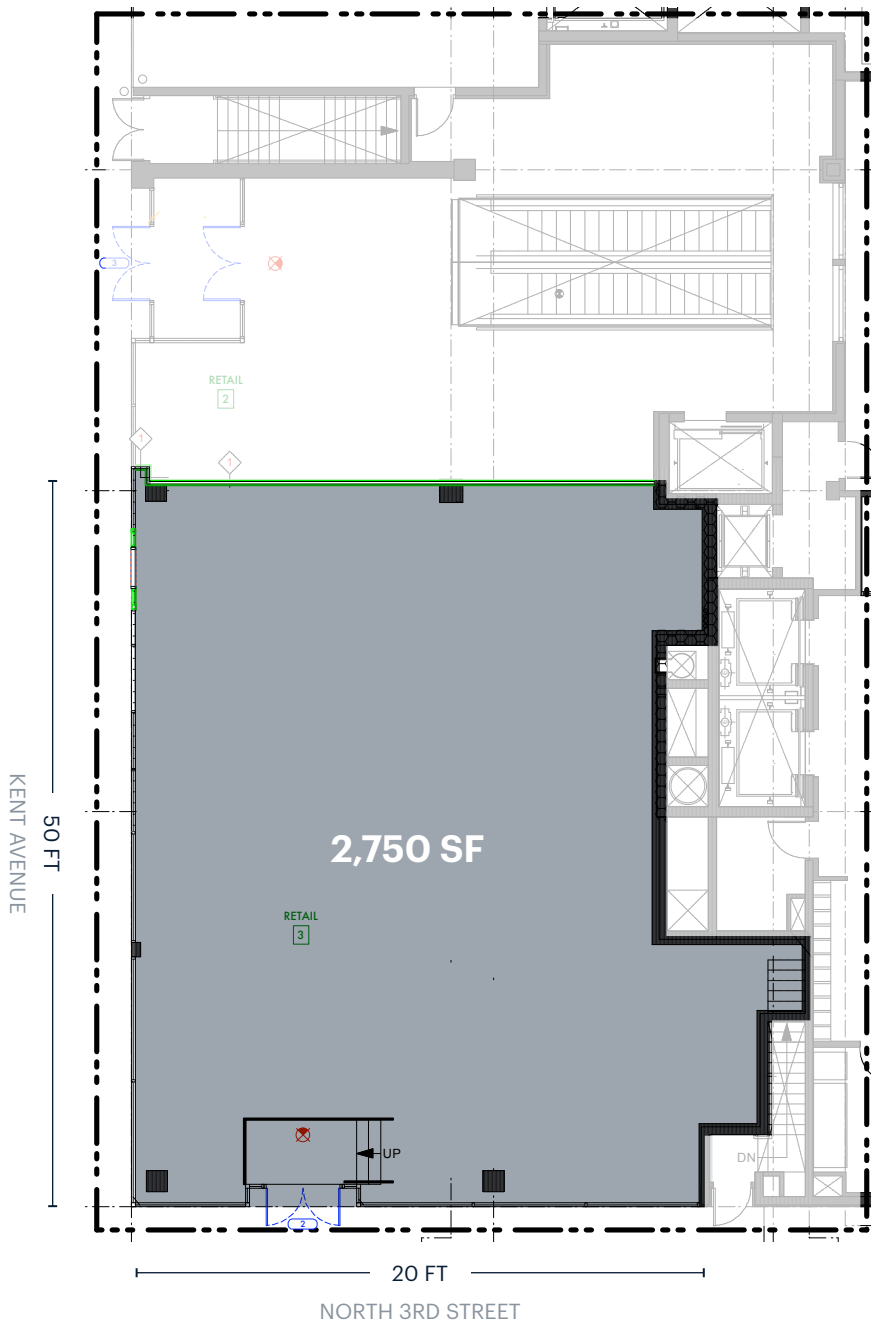

LOCATION

North side of North 3rd Street
between Kent and Wythe Avenues

SIZE

Ground Floor 2,750 SF

FRONTAGE

Kent Avenue 50 FT
North 3rd Street 20 FT

CEILING HEIGHTS

Ground Floor Approx. 14 FT

ASKING RENT

Upon Request

STATUS

Formerly Sobol and Krispy Krust

POSSESSION

Immediate

TRANSPORTATION

2022 Ridership Report

Bedford Avenue 
Annual 7,255,571
Weekday 20,035
Weekend 40,252

NEIGHBORS

Trader Joe's, Smorgasburg, Artists and Fleas, The Wythe Hotel, The Williamsburg Hotel, J. Crew, Brooklyn Bowl, Brooklyn Brewery, Williamsburg Music Hall, CVS, Brooklyn Harvest, PQ Coffee, Music Hall of Williamsburg, Rough Trade, Vans, Everlane, Pure Barre, Soul Cycle, Marine Layer, and Muji

COMMENTS

Across the street from Trader Joe's Williamsburg store
Clean former ice cream shop space
Walk in freezer in place and in good condition

East River Ferry 
Daily 11,903
Ridership approximately 6.1 Million in 2022

AREA RETAIL



175 KENT AVENUE

CONTACT EXCLUSIVE AGENTS

BEN WEINER
 bweiner@ripcony.com | 718.233.6565

BRENDAN REICHENBACHER
 ber@ripcony.com | 973.902.2436

RIPCO
 REAL ESTATE | 32 Court Street
 10th Floor
 Brooklyn, NY 11201
 718.233.6565

Please visit us at ripcony.com for more information

This information has been secured from sources we believe to be reliable, but we make no representations as to the accuracy of the information. References to square footage are approximate. Buyer must verify the information and bears all risk for any inaccuracies.