



1,850 SF
For Lease

**MEDICAL/QSR/RETAIL SPACE
RESTAURANT-PERMITTED**

81 COURT STREET

Southeast corner of Livingston Street

DOWNTOWN BROOKLYN/BROOKLYN HEIGHTS
BROOKLYN | NY

RIPCO
REAL ESTATE

SPACE DETAILS

GROUND FLOOR

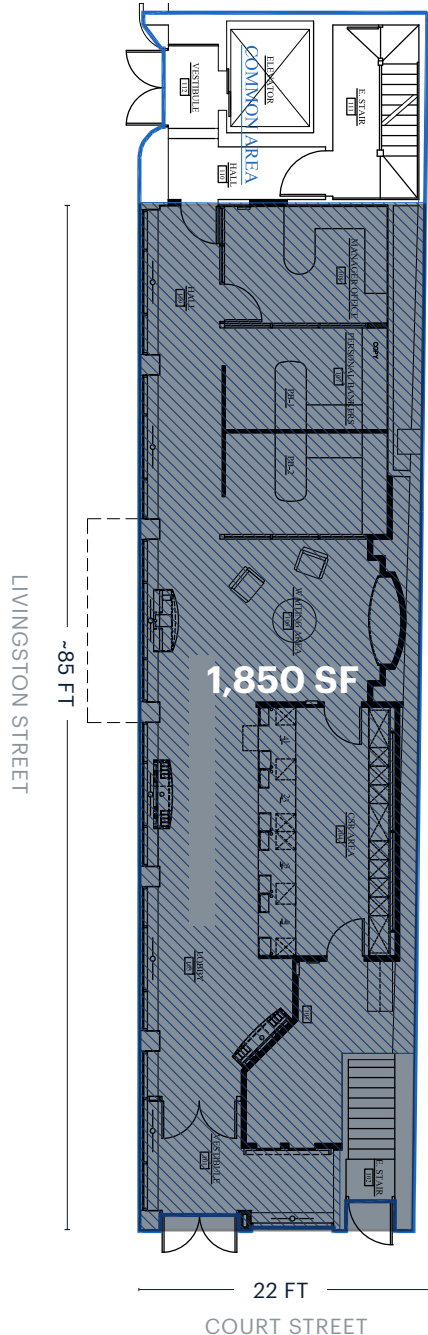

LOCATION

Southeast corner of Court and Livingston Streets

SIZE

Ground Floor 1,850 SF
+Associated Lower Level

FRONTAGE

Court Street 22 FT
Livingston Street ~85 FT

STATUS

Formerly Investors Bank

POSSESSION

1Q24

TERM

TBD

RENT

TBD

NEIGHBORS

Just Salad (coming soon), Taco Bell (coming soon), Paris Baguette, Sweet Green, Bank of America, T-Mobile, Dos Toros

TRANSPORTATION

2022 Ridership Report

Court Street/ Borough Hall

R 2 3 4 5

Annual 5,334,384
Weekday 17,809
Weekend 14,917

Jay Street- Metro Tech

A C F R

Annual 6,436,276
Weekday 21,319
Weekend 18,755

B25

B 25

Annual 1,543,338
Weekday 4,806
Weekend 5,908

B45

B 45

Annual 956,547
Weekday 3,093
Weekend 3,139

AREA RETAIL



CONTACT EXCLUSIVE AGENT

HYMIE M. DWECK
 hdweck@ripcony.com | 718.233.6565

RIPCO
 REAL ESTATE | 150 East 58th Street
 15th Floor
 New York, NY 10115
 212.750.6565

Please visit us at ripcony.com for more information

This information has been secured from sources we believe to be reliable, but we make no representations as to the accuracy of the information. References to square footage are approximate. Buyer must verify the information and bears all risk for any inaccuracies.