



1,850 SF
Ground Floor
1,850 SF
Cellar
For Lease

**QSR/RESTAURANT-EQUIPPED/
RETAIL SPACE**

235 KENT AVENUE

Between Grand and North 1st Streets

WILLIAMSBURG
BROOKLYN | NY

RIPCO
REAL ESTATE

SPACE DETAILS

GROUND FLOOR

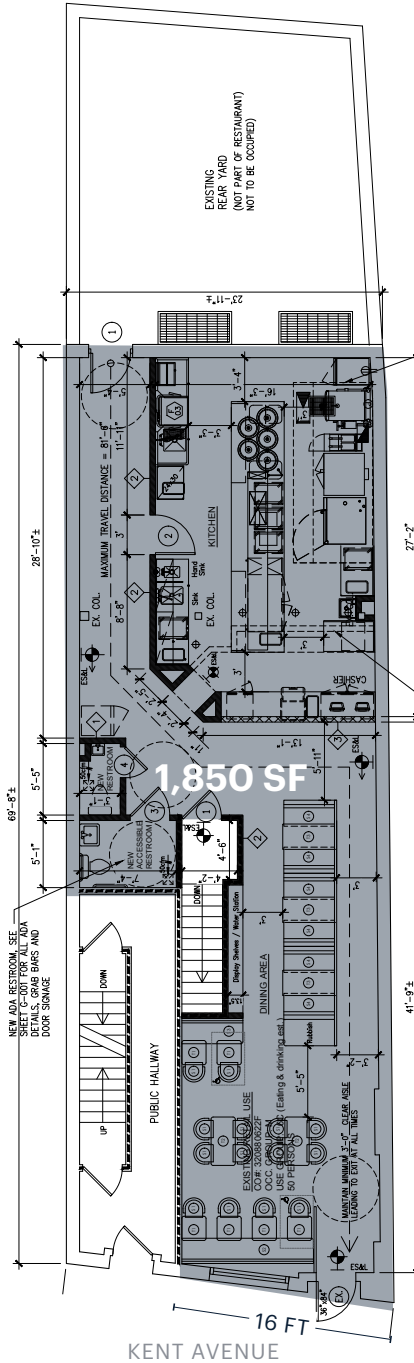

CELLAR

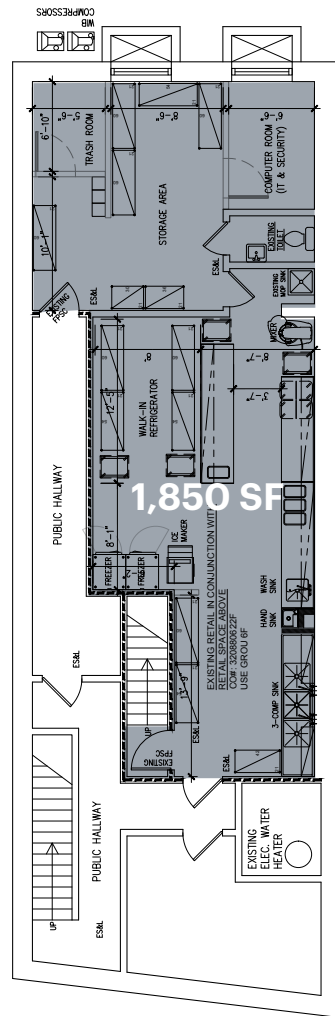

LOCATION

Between Grand and North 1st Streets

SIZE

Ground Floor	1,850 SF
Cellar	1,850 SF
Total	3,700 SF

FRONTAGE

Kent Avenue	16 FT
-------------	-------

CEILING HEIGHTS

Ground Floor	10 FT
--------------	-------

STATUS

Formerly Milu

POSSESSION

Arranged

RENT

Upon request

NEIGHBORS

Domino Sugar Development, Roberta's, Two Hands, Misipasta, Other Half Brewing, UME, Aurora, Planta, and Devocion

COMMENTS

Turnkey and fully-equipped 2nd generation restaurant space
 Equipment list provided upon request
 No Key Money
 1,000 SF backyard patio with retractable awning
 Active full liquor license
 Black iron venting in place
 600 AMPs power

TRANSPORTATION

2022 Ridership Report

Marcy Avenue	J M Z
Annual	2,540,327
Weekday	7,896
Weekend	9,774
Bedford Avenue	L
Annual	7,255,571
Weekday	20,035
Weekend	40,252
B32	B
Annual	197,385
Weekday	588
Weekend	890

Q59	59
Annual	1,629,007
Weekday	5,237
Weekend	5,454
B62 Bus	B 62
Annual	1,510,617
Weekday	4,540
Weekend	6,553
East River Ferry	ERF
Daily	11,903
Ridership approximately 6.1 Million in 2022	

INTERIOR PHOTOS



AREA RETAIL



**CONTACT
EXCLUSIVE
AGENT**

BRENDAN REICHENBACHER
ber@ripcony.com
718.233.6565