

RETAIL SPACE

53 BROADWAY

Between Wythe Avenue and Berry Street

WILLIAMSBURG

BROOKLYN | NY

1,913 SF

For Lease



RIPCO
REAL ESTATE

SPACE DETAILS

GROUND FLOOR

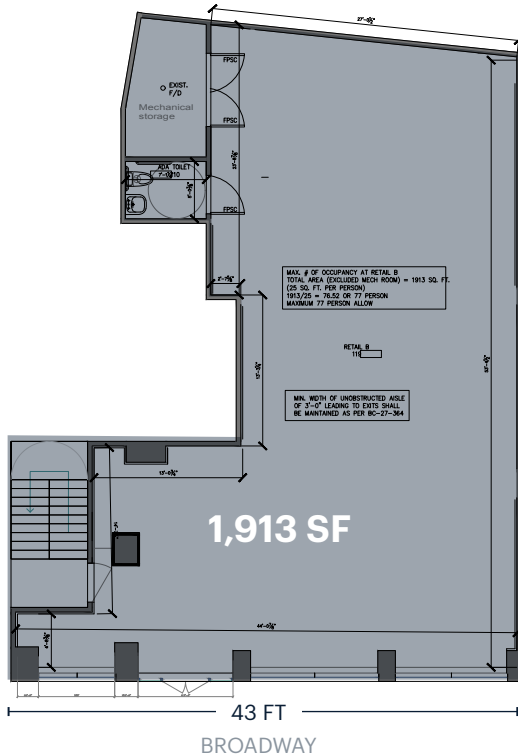

1,913 SF

43 FT
BROADWAY

LOWER LEVEL

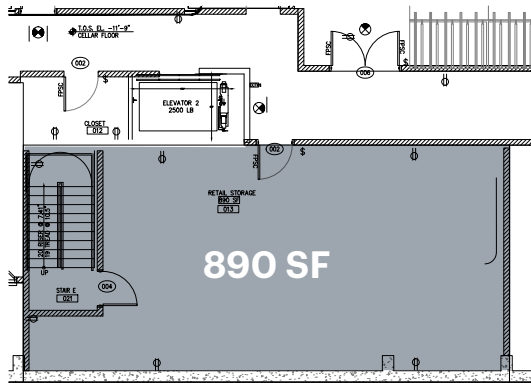

890 SF

LOCATION

North side of Broadway between Wythe Avenue and Berry Street

SIZE

Ground Floor 1,913 SF
Lower Level 890 SF

FRONTAGE

Broadway 43 FT

CEILING HEIGHTS

Ground Floor 10.5 FT
Lower Level 11 FT

STATUS

Formerly Fixture Showroom

POSSESSION

Immediate

RENT

Upon request

TERM

Arranged

NEIGHBORS

Peter Luger Steakhouse, Barano, City Acres Market, Domino Park, Xolo, Partizia's, Giando on the Water, Spirit Animal, Marlow & Sons, Diner, Deux Chats, PingPod, Baby's All Right, OTB, Meadowsweet, Motorino, Davidoff of Geneva, Pies 'N Thighs

COMMENTS

Located at the base of a 75-unit residential building
Situated along South Williamsburg's premier retail corridor

TRANSPORTATION

2022 Ridership Report

Marcy Avenue J M Z
Annual 2,540,327
Weekday 7,896
Weekend 9,774

Bedford Avenue L
Annual 7,255,571
Weekday 20,035
Weekend 40,252

B32 B 32
Annual 197,385
Weekday 588
Weekend 890

Q59 59
Annual 1,629,007
Weekday 5,237
Weekend 5,454

B62 Bus B 62
Annual 1,510,617
Weekday 4,540
Weekend 6,553

East River Ferry Ferry
Daily 11,903
Ridership approximately 6.1 Million in 2022



CONTACT EXCLUSIVE AGENTS

BEN WEINER
 bweiner@ripcony.com
 718.233.6565

BRENDAN REICHENBACHER
 ber@ripcony.com
 973.902.2436

RIPCO
 REAL ESTATE

32 Court Street
 10th Floor
 Brooklyn, NY 11201
 718.233.6565

Please visit us at ripcony.com for more information

This information has been secured from sources we believe to be reliable, but we make no representations as to the accuracy of the information. References to square footage are approximate. Buyer must verify the information and bears all risk for any inaccuracies.