

**RESTAURANT SPACE AVAILABLE**

# THE SHOPPES AT EDISON VILLAGE

161 Main Street at Lakeside Avenue

**ESSEX COUNTY**

WEST ORANGE | NEW JERSEY

Seeking  
Restaurant Use

**2,908 SF**

Restaurant Location  
with Potential for a  
Liquor License



**OUTDOOR  
SEATING AREA**

**RIPCO**  
REAL ESTATE

## SPACE DETAILS



### LOCATION

161 Main Street

### UNIT SIZE

2,908 SF

### POSSESSION

Immediate

### TOTAL GLA

18,537 SF

### RENT

Upon Request

### PARKING

90 parking spaces for exclusive retail use (free)

### RESIDENTIAL DEVELOPMENT

FULLY LEASED

- The Mews (34 units/1-2 bedroom apartments)
- The Loft Units (300 units/Studio, 1, 2, & 3 bedroom apartments)

### AMENITIES

31,700 sf of amenities to residential units. Including: courtyard, gym, pool, doggie spa, sky lounge, saunas and movie theater(s).



# FLOOR PLAN

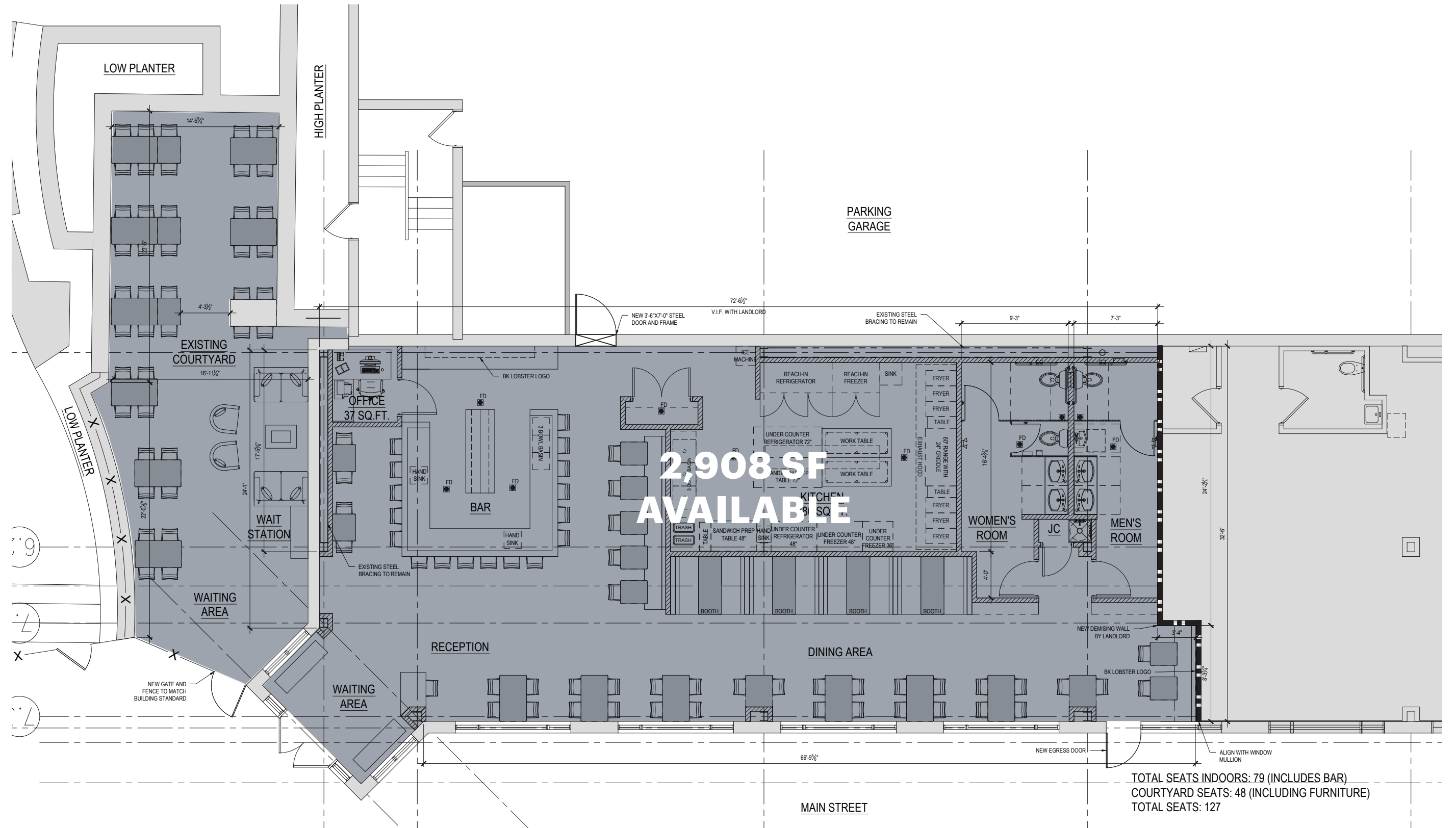

**THIS PLAN IS FOR ILLUSTRATION PURPOSES ONLY. IT SHOWS THE EXISTING WALLS, BATHROOMS, BAR AREA, AND OFFICE. TENANT TO FIT OUT THE SPACE COMPLETELY INCLUDING THE KITCHEN.**

# HIGH-LEVEL AERIAL

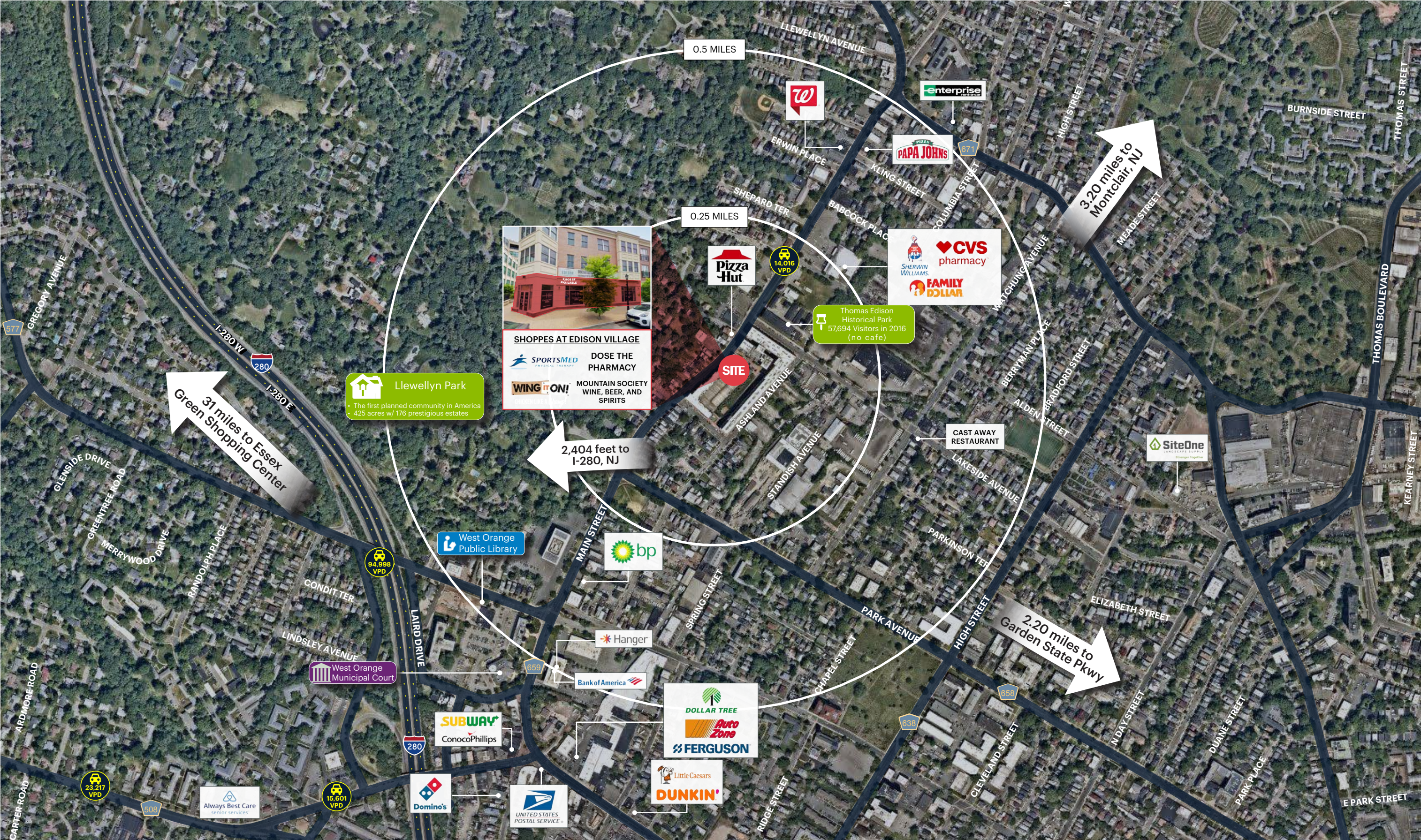

# AREA DEMOGRAPHICS

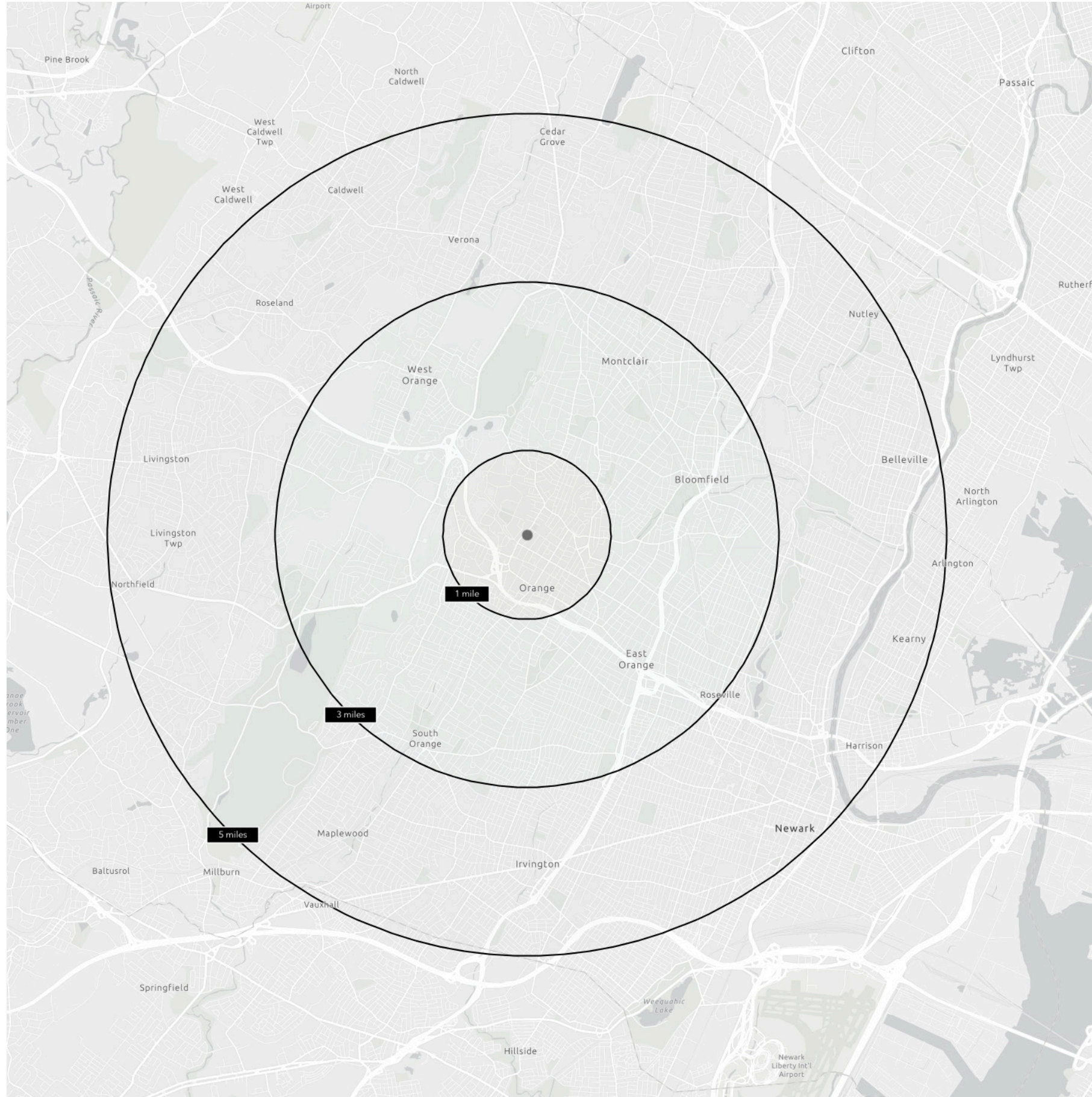

## **1 MILE RADIUS**

### **POPULATION**

35,929

### **HOUSEHOLDS**

13,040

### **MEDIAN AGE**

36.6

### **COLLEGE GRADUATES (Bachelor's +)**

29.0%

### **TOTAL BUSINESSES**

1,177

### **TOTAL EMPLOYEES**

10,416

### **AVERAGE HOUSEHOLD INCOME**

\$83,901

### **TOTAL DAYTIME POPULATION**

29,377

## **3 MILE RADIUS**

### **POPULATION**

276,025

### **HOUSEHOLDS**

104,579

### **MEDIAN AGE**

37.6

### **COLLEGE GRADUATES (Bachelor's +)**

37.0%

### **TOTAL BUSINESSES**

7,194

### **TOTAL EMPLOYEES**

81,902

### **AVERAGE HOUSEHOLD INCOME**

\$113,179

### **TOTAL DAYTIME POPULATION**

225,678

## **5 MILE RADIUS**

### **POPULATION**

761,587

### **HOUSEHOLDS**

282,800

### **MEDIAN AGE**

37.5

### **COLLEGE GRADUATES (Bachelor's +)**

39.0%

### **TOTAL BUSINESSES**

19,398

### **TOTAL EMPLOYEES**

297,595

### **AVERAGE HOUSEHOLD INCOME**

\$116,416

### **TOTAL DAYTIME POPULATION**

699,279

\*2023 estimates

## AREA COMPS

### Comparable Daytime Population

*Overall Daytime Population (3 miles)*

West Orange	123,022
Nutley	205,994
Montclair	180,232

### Highest Overall Population

*Overall Population (3 miles)*

West Orange	135,630
Nutley	256,219
Montclair	217,973

### Comparable Education Level

*Bachelor's Degree or Higher (3 miles)*

West Orange	56,371
Nutley	84,068
Montclair	78,316

### Comparable Avg. HH Income

*Average HH Income \$100k+ (3 miles)*

West Orange	\$180,447
Nutley	\$133,770
Montclair	\$147,025

## CONTACT EXCLUSIVE AGENT

### DEBORAH STONE

dstone@ripconj.com

201.914.4406



611 River Drive  
3rd Floor  
Elmwood Park, NJ 07407  
201.777.2300

Please visit us at [ripcony.com](http://ripcony.com) for more information

This information has been secured from sources we believe to be reliable, but we make no representations as to the accuracy of the information. References to square footage are approximate. Buyer must verify the information and bears all risk for any inaccuracies.