

**RETAIL/OFFICE/MIXED USE**

# 2610-2618 FREDERICK DOUGLASS BLVD

Northeast corner of Frederick Douglass Boulevard. (Also known as 267 West 139th Street)

**HARLEM**

NEW YORK | NY

**1,500 SF**

(Combined Spaces)

For Lease



**RIPCO**  
REAL ESTATE

# SPACE DETAILS

## GROUND FLOOR

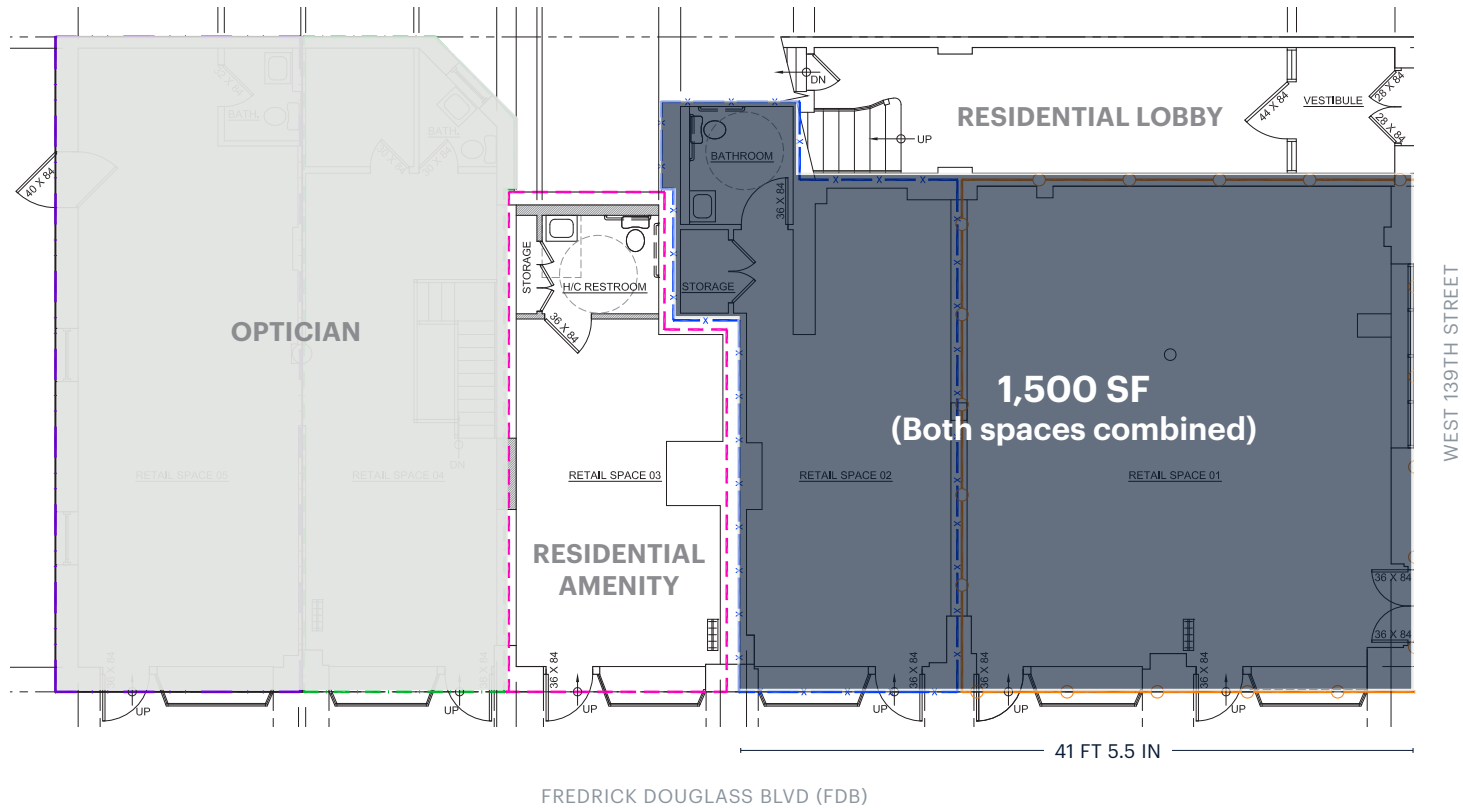

### LOCATION

Northeast corner of Frederick Douglass Boulevard and 139th Street

### SIZE

Ground Floor (total) 1,500 SF

### ASKING RENT

Upon Request

### FRONTAGE (COMBINED)

41 FT 5.5 IN on Fredrick Douglass Blvd

### POSSESSION

Immediate

### CURRENTLY

Vacant

### NEIGHBORS

Londel's, Manhattanville Coffee, The Vanity Box, Key Food Supermarket, Make My Cake, Ponty Bistro

### COMMENTS

All quality uses considered

Join the burgeoning arts, boutiques and dining scene of Brownstone Harlem

Located off Harlem's prestigious Striver's Row

Large bay windows

### TRANSPORTATION

2021 Ridership Report

#### 135th Street

|         | <b>B C</b> |
|---------|------------|
| Annual  | 753,875    |
| Weekday | 2,433      |
| Weekend | 2,492      |

#### 145th Street

|         | <b>A C B D</b> |
|---------|----------------|
| Annual  | 3,468,964      |
| Weekday | 10,513         |
| Weekend | 14,624         |



## AREA RETAIL



## CONTACT EXCLUSIVE AGENTS

**JASON PENNINGTON**

jpennington@ripcony.com  
718.233.6565

**JESSICA HEDRINGTON**

jhedrington@ripcony.com  
718.233.6565

**RIPCO**  
REAL ESTATE

32 Court Street  
10th Floor  
Brooklyn, NY 11201  
718.233.6565

Please visit us at [ripcony.com](http://ripcony.com) for more information

This information has been secured from sources we believe to be reliable, but we make no representations as to the accuracy of the information. References to square footage are approximate. Buyer must verify the information and bears all risk for any inaccuracies.