

FITNESS / MEDICAL / BIG BOX / STREET RETAIL

751 AVENUE OF THE AMERICAS

Southwest corner of West 25th Street

CHELSEA
MANHATTAN | NY

11,000 SF

For Lease



SPACE DETAILS

GROUND FLOOR

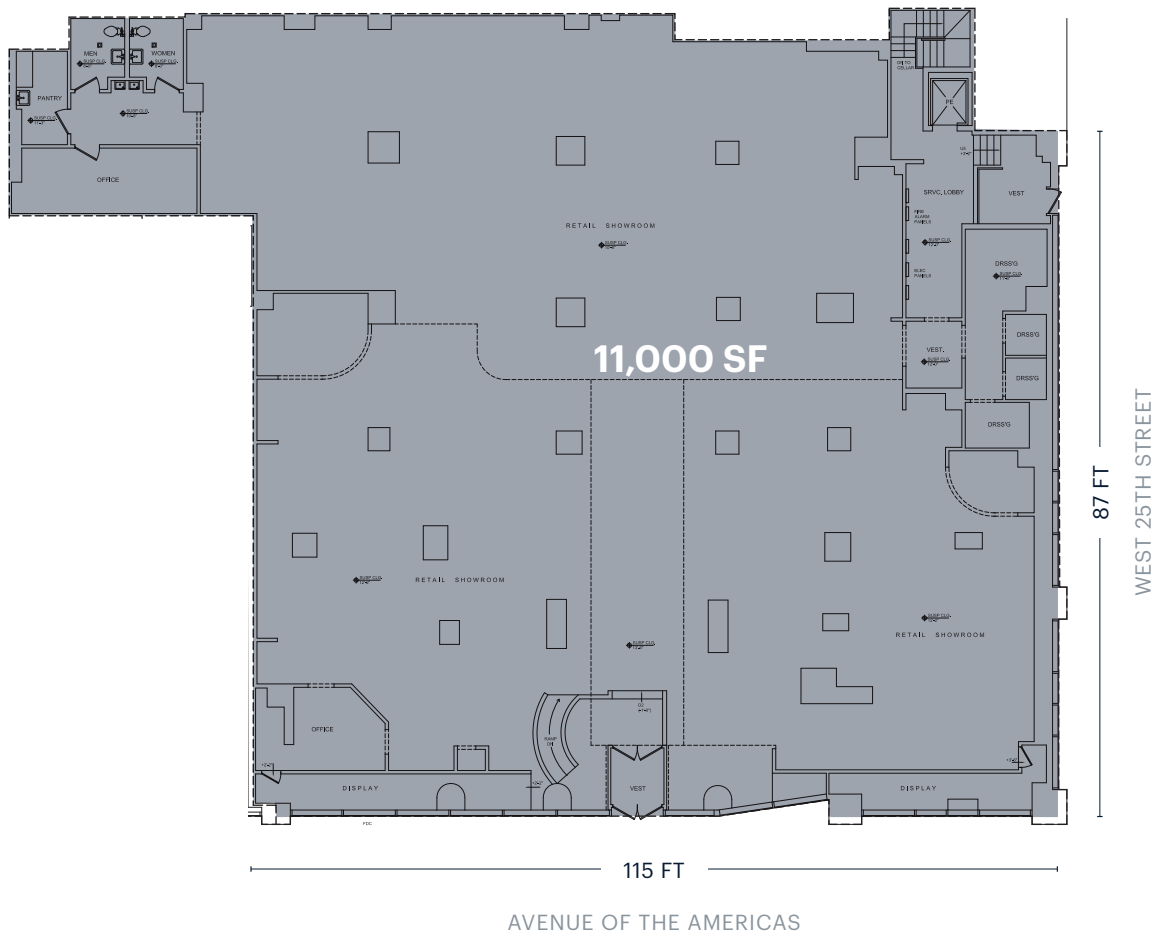

LOCATION

Southwest corner of West 25th Street

SIZE

Ground Floor	11,000 SF
Lower Level	1,500 SF
Total	12,500 SF

STATUS

Currently vacant

FRONTAGE

Avenue of the Americas	115 FT
West 25th Street	87 FT

CEILING HEIGHTS

Ground Floor	10 FT 7 IN - 12 FT
Lower Level	7 FT 10 IN

POSSESSION

Immediate

RENT

Upon request

NEIGHBORS

CVS pharmacy, Fairway, Starbucks, Veterinary Emergency Group, NYC Wine Merchants and Everytable

COMMENTS

Tremendous frontage along Avenue of the Americas
Retail space located in 200 unit luxury condominium building

Steps from the 23rd Street and 6th Avenue subway F/M trains with 3,240,722 in annual ridership (2021)

The PATH train is also located at 23rd Street with 858,461 in annual ridership (2021)

AREA RETAIL

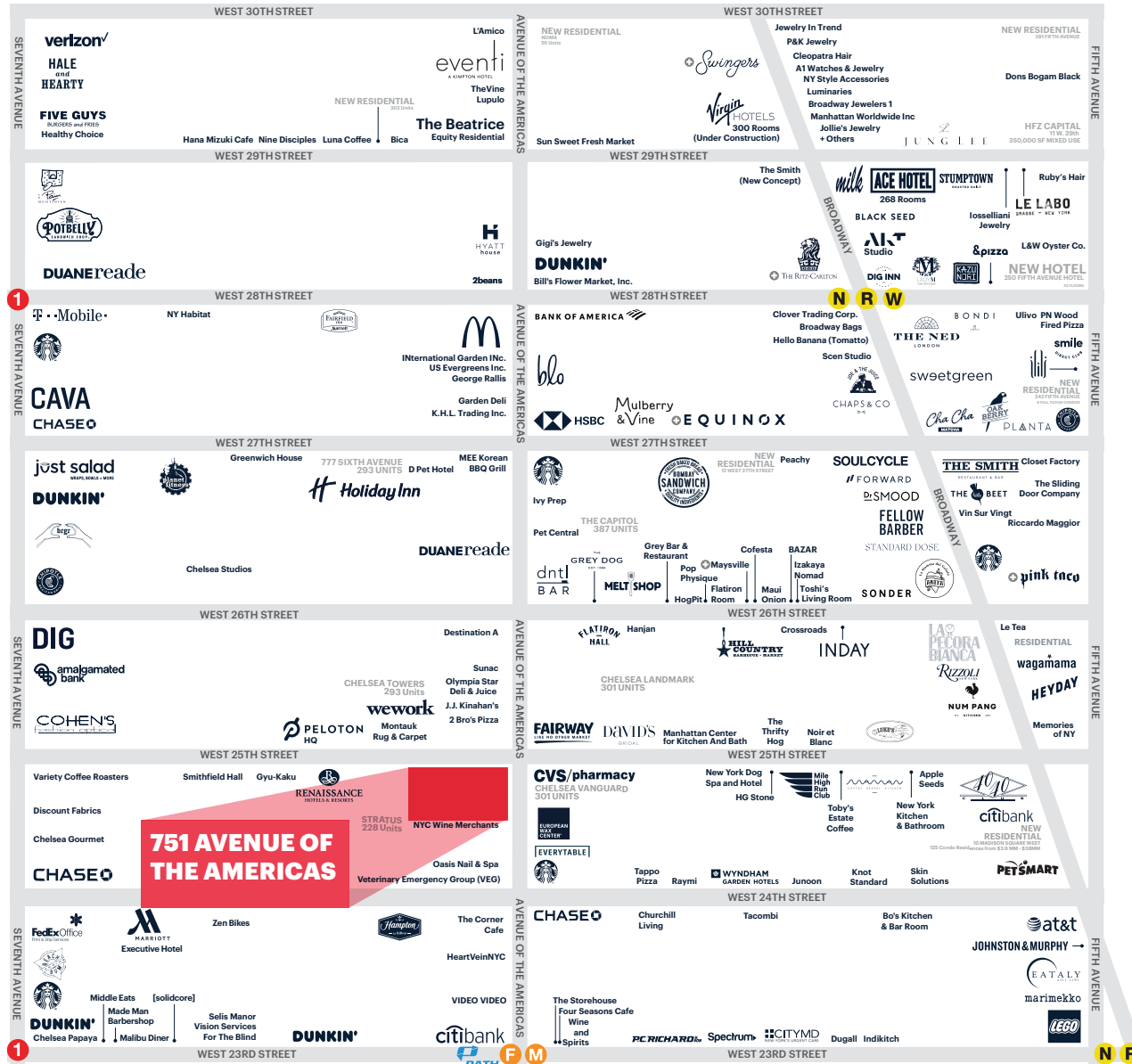

+ Coming Soon

RIPCO
REAL ESTATE

150 East 58th Street
15th Floor
New York, NY 10115
212.750.6565

Please visit us at ripcony.com for more information

This information has been secured from sources we believe to be reliable, but we make no representations as to the accuracy of the information. References to square footage are approximate. Buyer must verify the information and bears all risk for any inaccuracies.

CONTACT EXCLUSIVE AGENTS

RICHARD SKULNIK

rskulnik@ripcony.com
212.750.0756

LINDSAY ZEGANS

lzegans@ripcony.com
646.827.9962

BEN SABIN

bsabin@ripcony.com
646.290.2018

MARY SCHWAGERL

mschwagerl@ripcony.com
212.230.5887