

RESTAURANT-EQUIPPED/RETAIL SPACE

680 COLUMBUS AVENUE

Northwest Corner of 93rd Street

UPPER WEST SIDE

MANHATTAN | NY

2,500 SF*

For Lease

**Up to 6,900 SF if
combined with 688
Columbus Avenue*



ARTIST'S RENDERING

RIPCO
REAL ESTATE

SPACE DETAILS

GROUND FLOOR

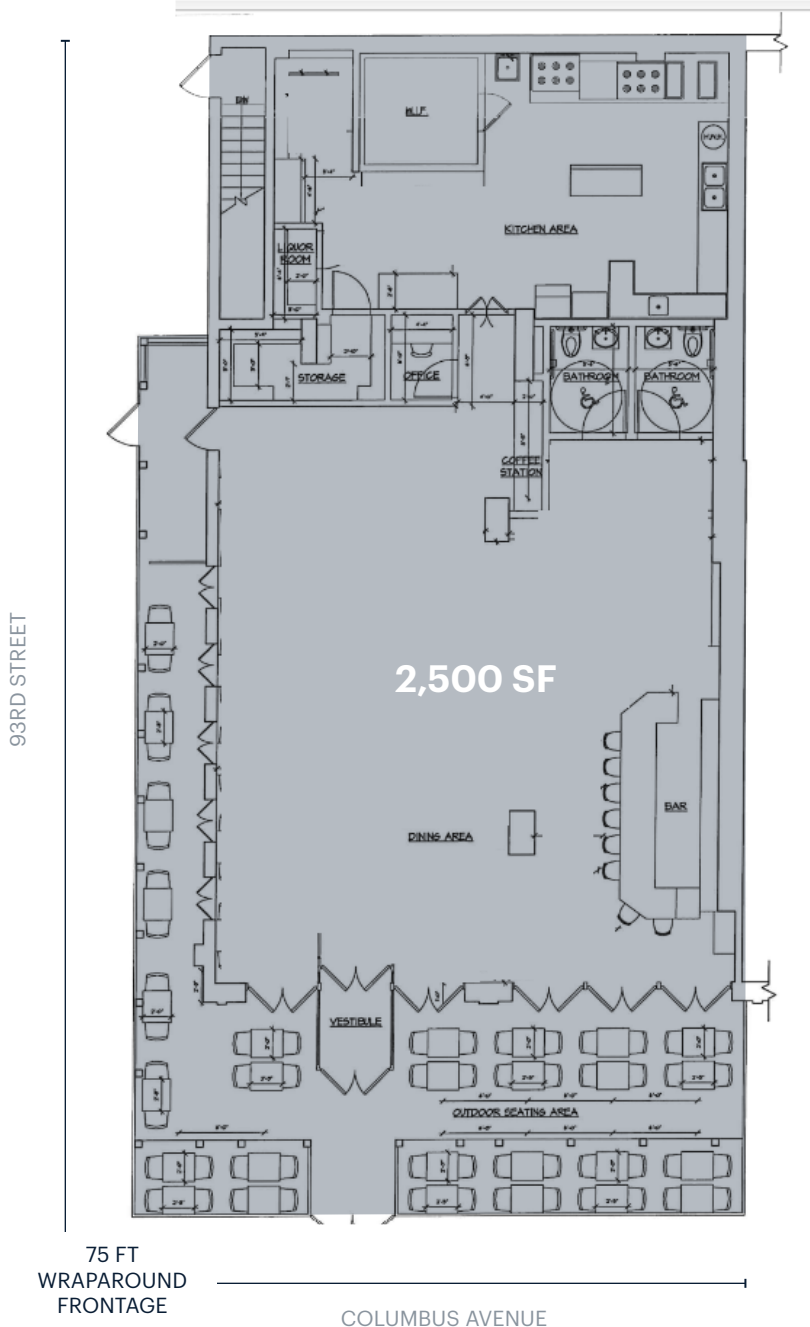

LOCATION

Northwest corner of 93rd Street

SIZE

Ground Floor 2,500 SF*

*Up to 6,900 SF if combined with 688 Columbus Avenue

FRONTAGE

Wraparound 75 FT

CEILING HEIGHTS

Ground Floor 14 FT

STATUS

Formerly Amsterdam Burger Co.

POSSESSION

Immediate

TERM

10-15 years

RENT

TBD

NEIGHBORS

Trader Joe's, Just Salad, Duane Reade, Whole Foods, TJ Maxx, Home Goods, Party City, Mt Sinai, Birch Coffee, Orange Theory, Peaky Barista, Satori Laser (coming soon)

COMMENTS

Fixtured restaurant space with great corner visibility

60+ Covered outdoor/cafe seats

TRANSPORTATION

2021 Ridership Report

96th Street

Annual	1,478,303
Weekday	4,824
Weekend	4,670



Columbus Avenue

Annual	1,878,769
Weekday	5,576
Weekend	4,476



Columbus Avenue

Annual	1,882,057
Weekday	6,029
Weekend	6,371



Amsterdam Avenue

Annual	1,018,456
Weekday	3,058
Weekend	4,418



AREA RETAIL



CONTACT EXCLUSIVE AGENTS

DOUG KLEIMAN

dkleiman@ripcony.com | 212.750.6565

ERIC FISHER

efisher@ripcony.com | 914.393.5564

RIPCO
REAL ESTATE

150 East 58th Street
15th Floor
New York, NY 10155
212.750.6565

Please visit us at ripcony.com for more information

This information has been secured from sources we believe to be reliable, but we make no representations as to the accuracy of the information. References to square footage are approximate. Buyer must verify the information and bears all risk for any inaccuracies.