

RETAIL SPACE

5 WEST 20TH STREET

Between Fifth Avenue and Avenue of the Americas

FLATIRON

MANHATTAN | NY

2,576 SF

For Lease



SPACE DETAILS

GROUND FLOOR

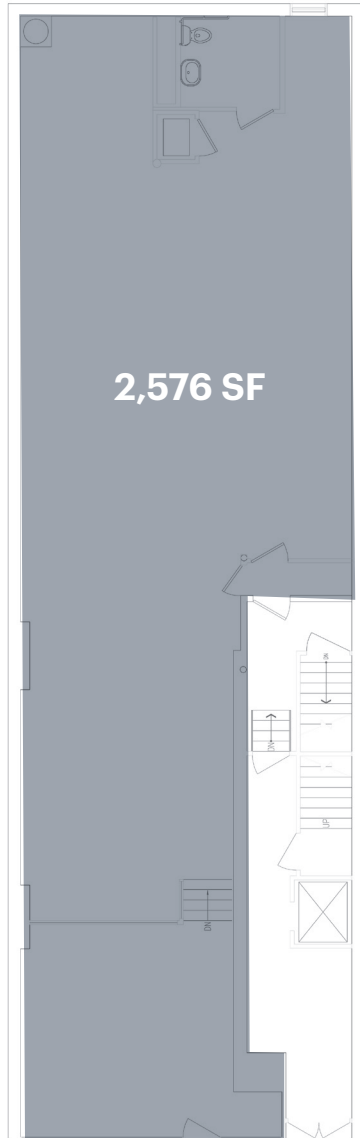

22.5 FT

20TH STREET

LOCATION

Between Fifth Avenue and Avenue of the Americas

SIZE

Ground Floor 2,576 SF
Basement Storage 2,000 SF

FRONTAGE

20th Street 22.5 FT

CEILING HEIGHTS

Ground Floor 10 FT

STATUS

Currently PID Floors

RENT

Upon request

POSSESSION

Jan 1, 2024

TERM

Long term

NEIGHBORS

Madewell, Rejuvenation, Gap, New Balance, Pottery Barn

COMMENTS

Highly visible and steps from Flatiron's heavily trafficked Fifth Avenue retail corridor

All uses considered

DEMOGRAPHIC

Average household income \$232,699
Total daytime population 233,226

TRANSPORTATION

2021 Ridership Report

23rd Street **R W**
Annual 2,468,679
Weekday 7,231
Weekend 11,662

23rd Street **1**
Annual 1,843,351
Weekday 5,583
Weekend 7,841

23rd Street **F M**
Annual 3,240,722
Weekday 10,426
Weekend 10,956

23rd Street **6**
Annual 2,985,473
Weekday 9,909
Weekend 8,693

