



Up To
**Approx.
6,000 SF***
For Lease
*Divisible

RETAIL SPACE/FREESTANDING/RESTAURANT

25-20 43RD AVENUE

Northwest Corner of 43rd Avenue and Hunter Street

LONG ISLAND CITY
QUEENS | NY

RIPCO
REAL ESTATE

FLOORPLANS

GROUND FLOOR - DIVISION PLAN A

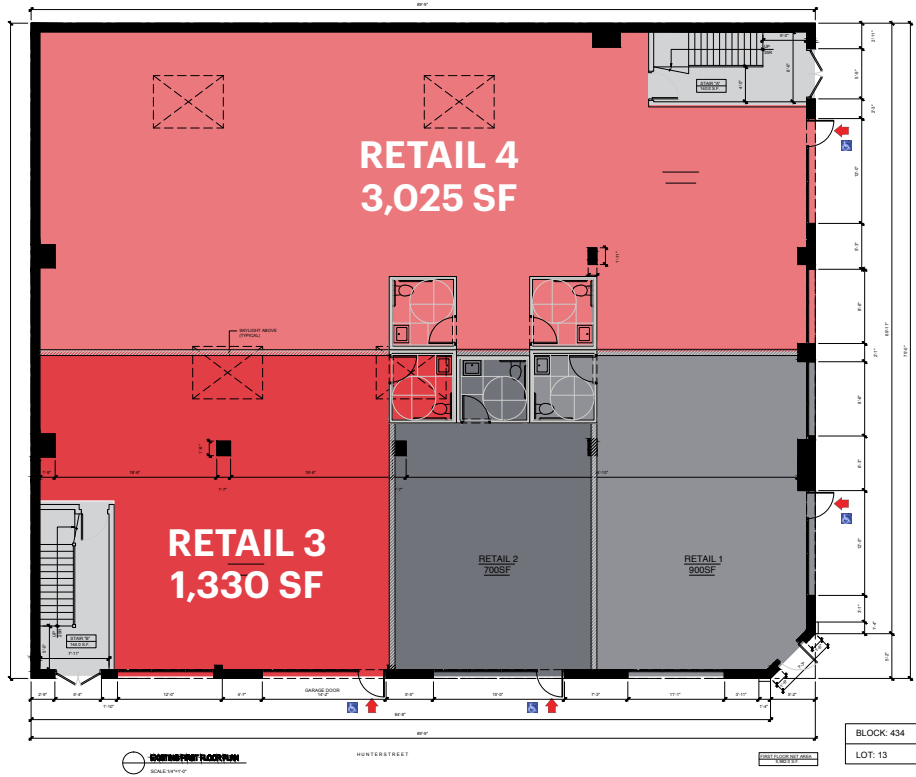

GROUND FLOOR - DIVISION PLAN B

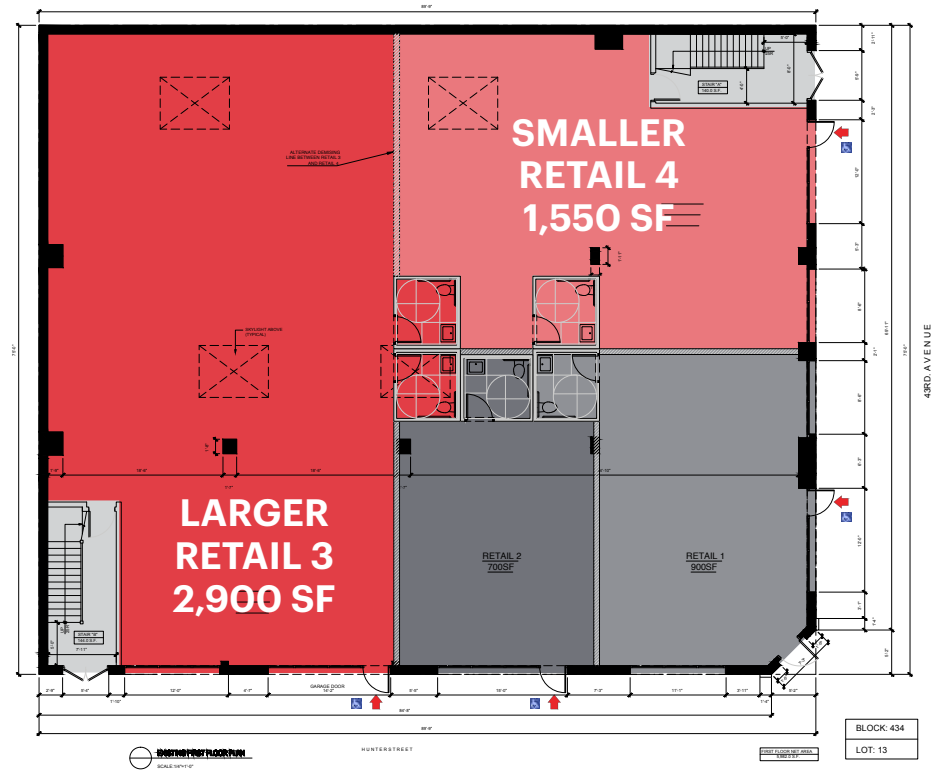

AREA RETAIL/ SPACE DETAILS



LOCATION

Northwest Corner of 43rd Avenue and Hunter Street

SIZE

Ground Floor ~6,000 SF*
 Second Floor 3,500 SF
 *Divisible

FRONTAGE

43rd Avenue 75 FT
 Hunter Street 90 FT

CEILING HEIGHTS

Ground Floor 15 FT+
 Second Floor 15 FT+

POSSESSION

Immediate

FORMERLY

Industrial/warehouse

RENT

Negotiable

NEIGHBORS

Tacombi, Food Cellar, Spear PT, Sweetgreen, Xian Famous Foods, Partners Coffee

COMMENTS

Converted former industrial building in the heart of Court Square
 High ceilings - potential for full building branding
 Ideal for Bar/Beer Garden/ Entertainment/Restaurant uses
 All uses considered
 Multiple division scenarios considered
 4 brand new skylights

TRANSPORTATION

2022 Ridership Report

Station	Annual	Weekday	Weekend
Queens Plaza (E, M, R)	2,662,316	8,662	8,481
Court Square (7, E, M, G)	4,426,924	14,127	15,364

CONTACT EXCLUSIVE AGENT

ERIC FISHER

efisher@ripcony.com
 914.393.5564



32 Court Street
 10th Floor
 Brooklyn, NY 11201
 718.233.6565

Please visit us at ripcony.com for more information

This information has been secured from sources we believe to be reliable, but we make no representations as to the accuracy of the information. References to square footage are approximate. Buyer must verify the information and bears all risk for any inaccuracies.