

BIG BOX/FITNESS/MEDICAL/NEW DEVELOPMENT/QSR/RESTAURANT-PERMITTED/STREET RETAIL

990 FULTON STREET

Located on the Ground Floor of Luxury Rental Building Arris Grand (445 Grand Avenue)

CLINTON HILL
BROOKLYN | NY

Up to
7,154 SF
For Lease



ARTIST'S RENDERING

RIPCO
REAL ESTATE

SPACE DETAILS

GROUND FLOOR

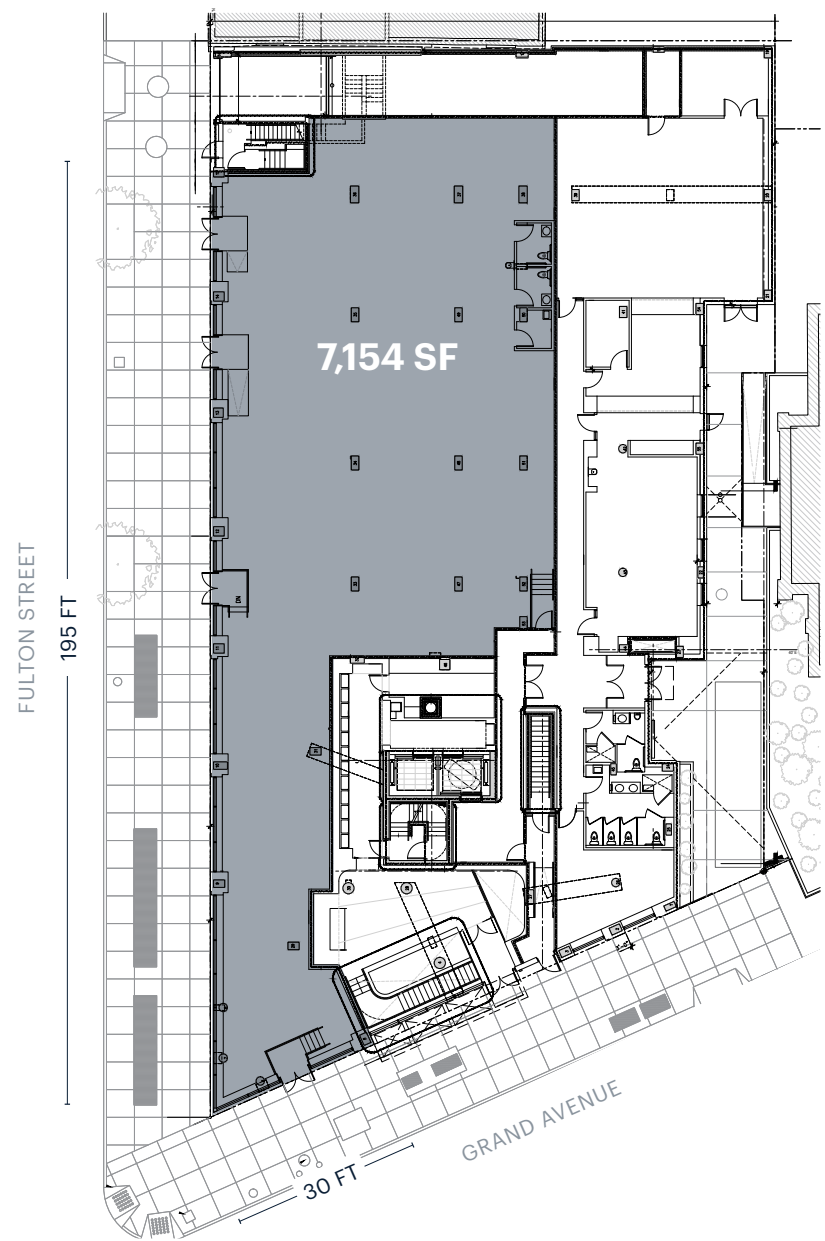

LOCATION

Southeast Corner of Fulton Street and Grand Avenue

SIZE

Ground Floor 7,154 SF*
*Divisible

FRONTAGE

Fulton Street 195 FT
Grand Avenue 30 FT

CEILING HEIGHTS

Ground Floor 16.5 FT

STATUS

New Construction

TERM

Negotiable

RENT

Upon request

NEIGHBORS

Sisters, Xochitl Taqueria, Prema Yoga, The Good Batch Bakery, Sweet bee, Doris, The Fly, Hart’s, Otway, Hops Hill, Emily Pizza



COMMENTS

New Construction in Clinton Hill
All uses considered
Multiple divisions considered
113-unit luxury rental apartments above
Steps to Franklin Avenue C train

TRANSPORTATION

2021 Ridership Report

Clinton-Washington Avenues	
Annual	916,121
Weekday	2,868
Weekend	3,474

Franklin Avenue	 
Annual	874,945
Weekday	2,624
Weekend	3,814

B25	
Annual	1,449,862
Weekday	4,534
Weekend	5,460

B26	
Annual	1,516,158
Weekday	4,619
Weekend	6,294

AREA RETAIL

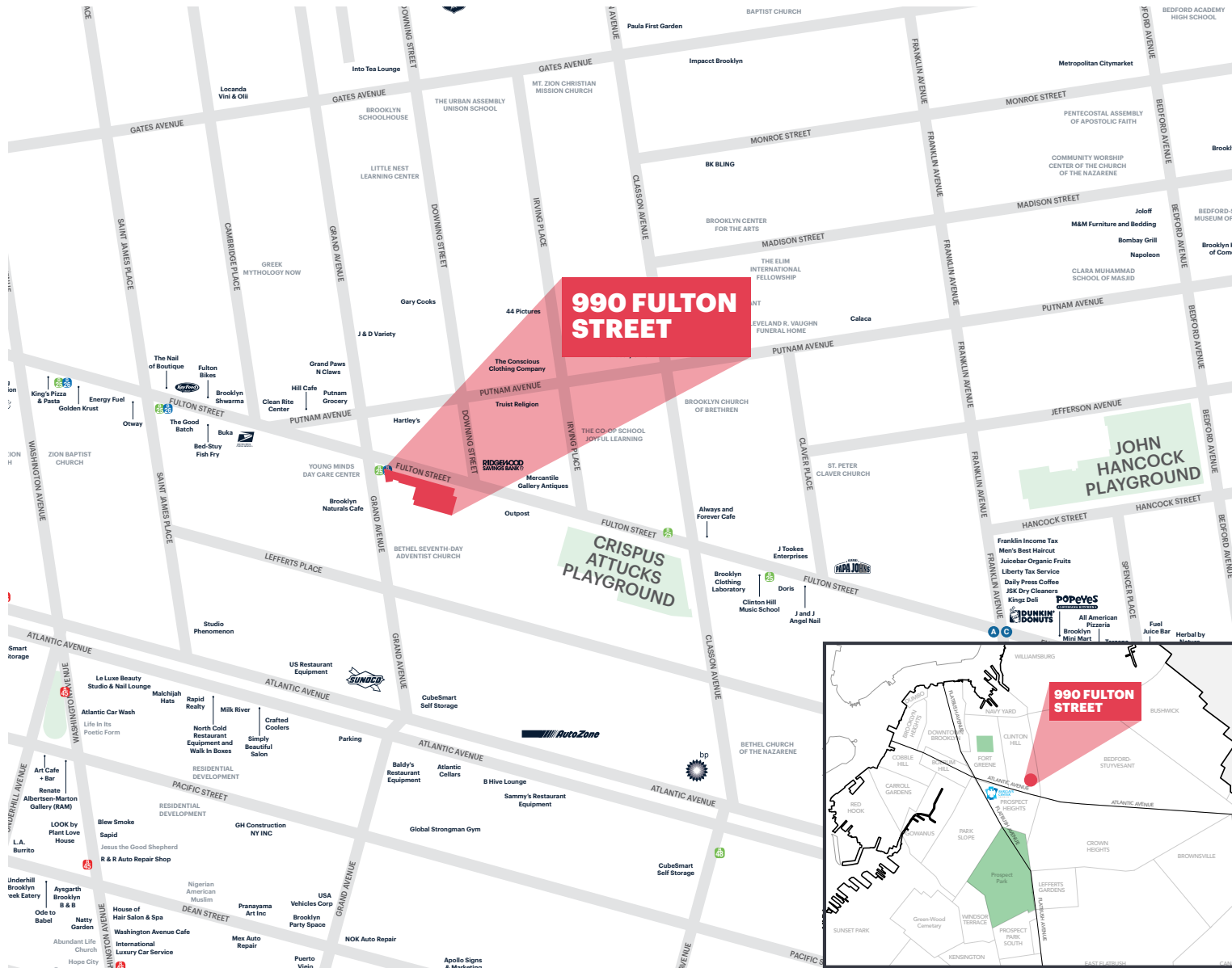

CONTACT EXCLUSIVE AGENTS

JASON PENNINGTON

jpennington@ripcony.com
718.233.6565

ALEX BEARD

abeard@ripcony.com
718.233.6565

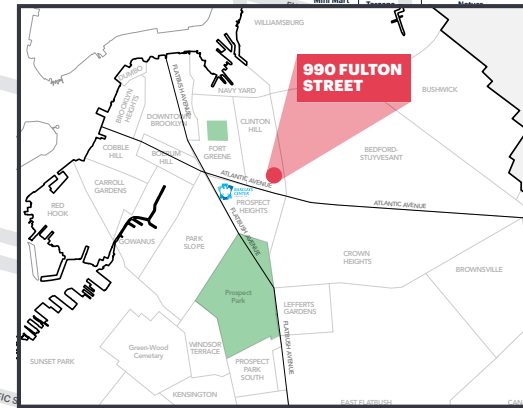

RIPCO
REAL ESTATE

32 Court Street
10th Floor
Brooklyn, NY 11201
718.233.6565

Please visit us at ripcony.com for more information

This information has been secured from sources we believe to be reliable, but we make no representations as to the accuracy of the information. References to square footage are approximate. Buyer must verify the information and bears all risk for any inaccuracies.