

**FITNESS/MEDICAL/QSR/NEW DEVELOPMENT/RESTAURANT/STREET RETAIL**

# 10-27 JACKSON AVENUE

At the Intersection of Jackson & 50th Avenues

**LONG ISLAND CITY**

QUEENS | NY

Up to  
**Approx.  
4,000 SF\***  
For Lease  
\*Divisible



ARTIST'S RENDERING

**RIPCO**  
REAL ESTATE

## SPACE DETAILS

### GROUND FLOOR

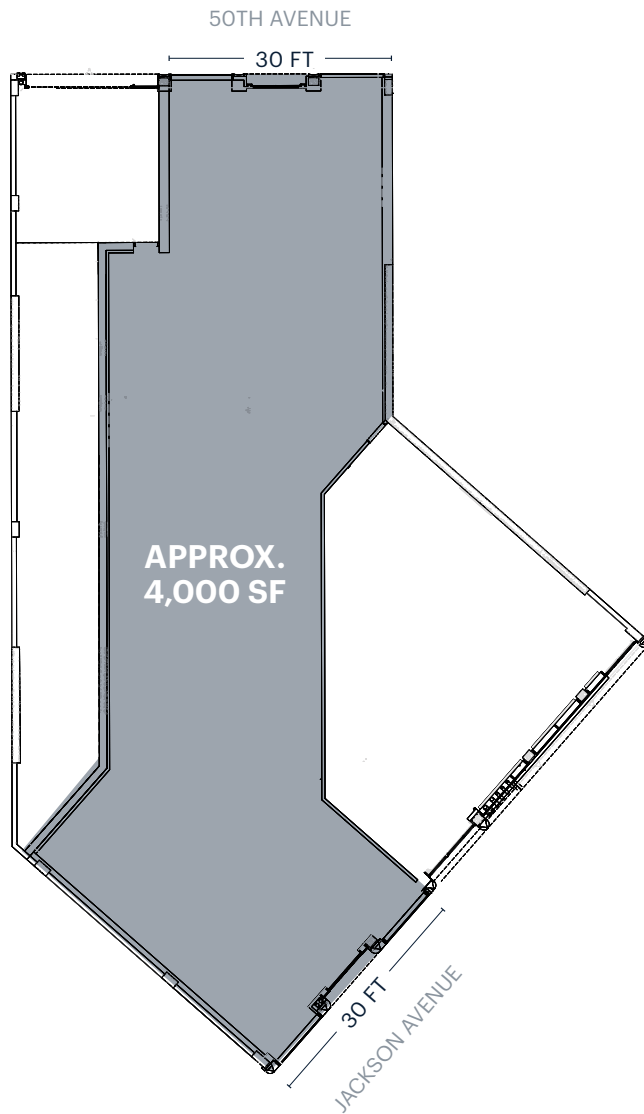

### LOCATION

At the Intersection of Jackson & 50th Avenues

### SIZE

Ground Floor Approx. 4,000 SF\*

\*Divisible

### FRONTAGE

50th Avenue 30 FT

Jackson Avenue 30 FT

### CEILING HEIGHTS

Ground Floor 10 FT+

### ASKING RENT

Upon Request

### TERM

Negotiable

### CURRENTLY

New Development (Delivery TBD)

### POSSESSION

Arranged

### NEIGHBORS

Casa Enrique, Cafe Henri, Prohealth Dental, Jackson's Eatery, Black Star Bakery, Chase, Yumpling

### COMMENTS

All logical divisions considered  
Brand new retail spaces in the heart of LIC  
Ideal for all uses  
Visibility from Jackson and 50th Avenues, directly across from Vernon/Jackson subway station  
32 self-parking spots

---

### TRANSPORTATION

2019 Ridership Report

Vernon Blvd - Jackson Ave **7**

Annual 4,623,070

Weekday 15,151

Weekend 14,033

# AREA RETAIL

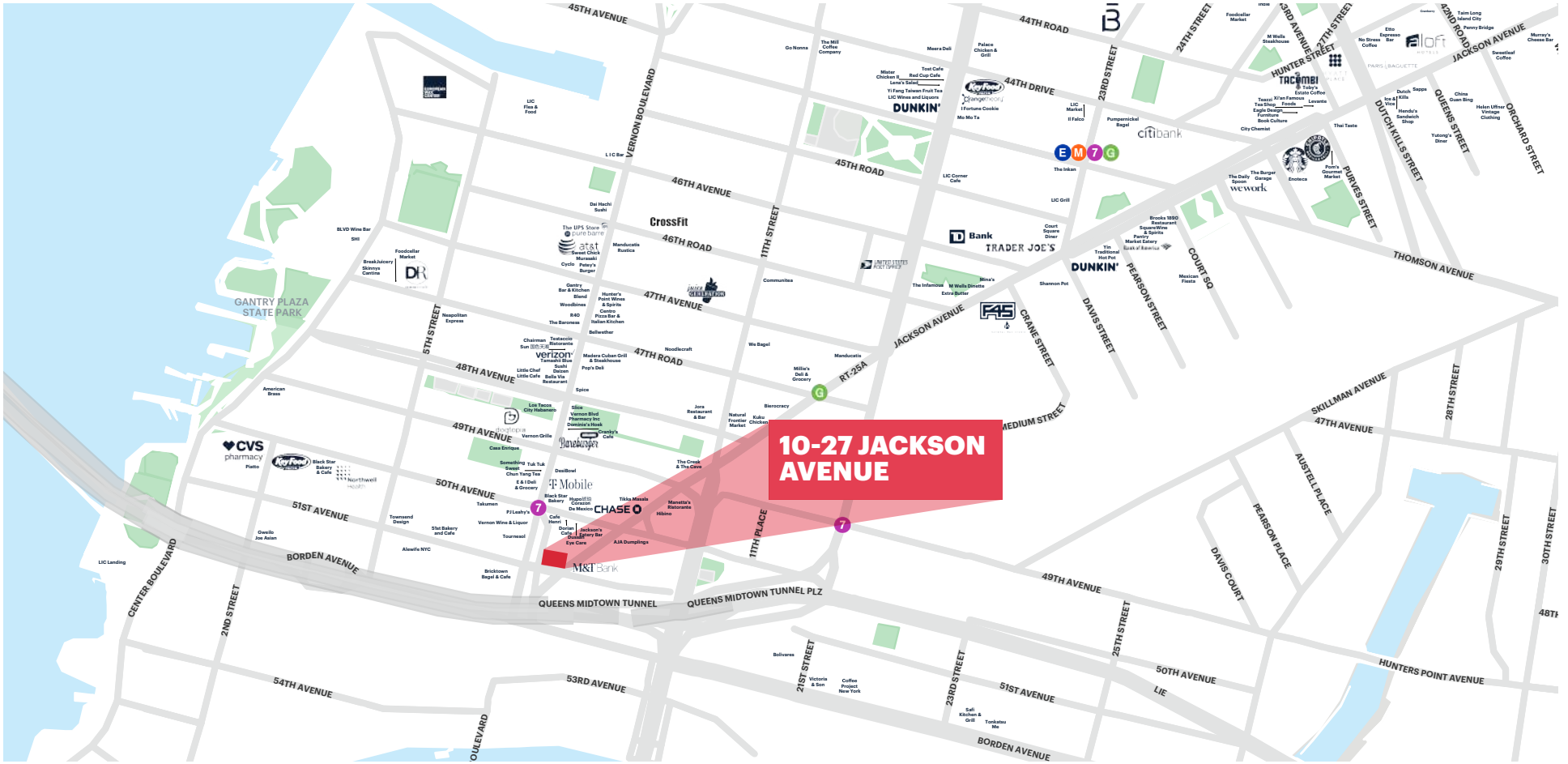

## CONTACT EXCLUSIVE AGENTS

**JASON PENNINGTON**

jpennington@ripcony.com  
718.233.6565

**ALEX BEARD**

abeard@ripcony.com  
718.233.6565

**ERIC FISHER**

efisher@ripcony.com  
718.233.6565

**RIPCO**  
REAL ESTATE

32 Court Street  
10th Floor  
Brooklyn, NY 11201  
718.233.6565

Please visit us at [ripcony.com](http://ripcony.com) for more information

This information has been secured from sources we believe to be reliable, but we make no representations as to the accuracy of the information. References to square footage are approximate. Buyer must verify the information and bears all risk for any inaccuracies.