

RETAIL/RESTAURANT SPACE

300 WEST 125TH STREET

Between Frederick Douglass Boulevard and St. Nicholas Avenue

HARLEM

NEW YORK | NY

19,120 SF

Available for Lease



SPACE DETAILS

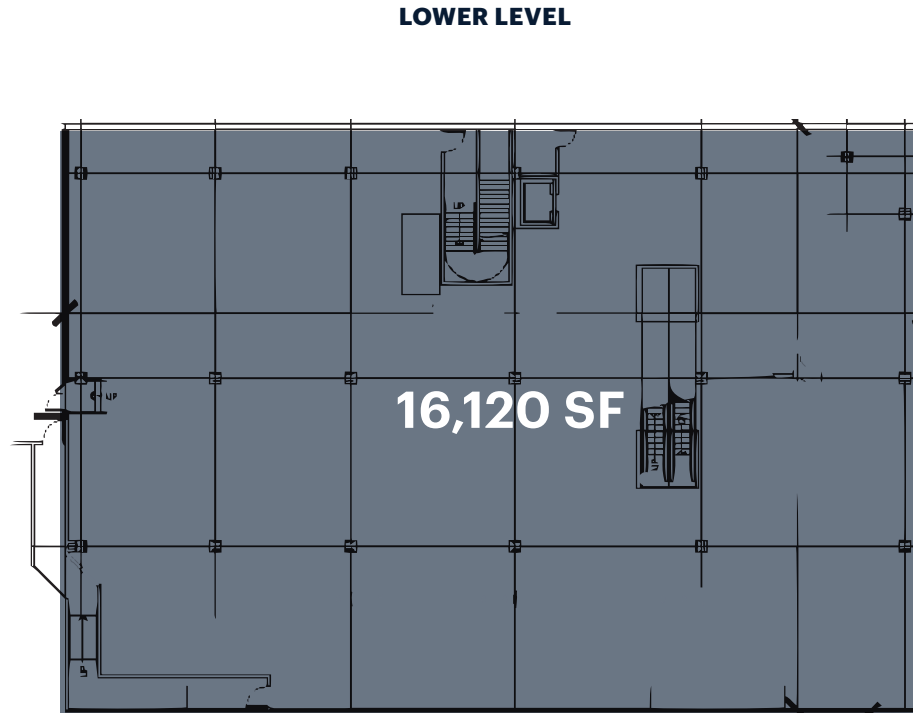
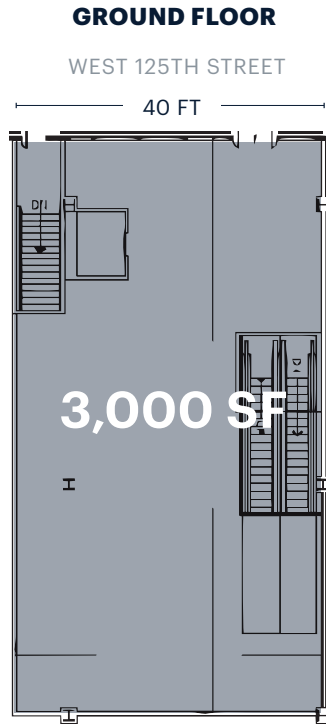

LOCATION

Located on 125th Street between Frederick Douglass Blvd and St. Nicholas Ave

SIZE

| | |
|--------------|------------------|
| Ground Floor | 3,000 SF |
| Lower Level | 16,120 SF |
| Total | 19,120 SF |

FRONTAGE

| | |
|-------------------|-------|
| West 125th Street | 40 FT |
|-------------------|-------|

ASKING RENT

Upon Request

CURRENTLY

Vacant

POSSESSION

Arranged

NEIGHBORS

Magic Johnson Theatre, H&M, Marshalls, Starbucks, Apollo Theatre, Gap Outlet, Blink Fitness, DSW, Red Lobster, Party City, Banana Republic Factory Outlet, Old Navy, CVS, Whole Foods, Burlington Coat Factory, American Eagle, TD Bank

COMMENTS

Second generation retail space
 Amazing signage and branding opportunity in the most recognized building on the 125th Street corridor
 Direct access to A, B, C, D subway entrances

TRANSPORTATION

2019 Ridership Report

| | |
|---------------------|----------------|
| 125th Street | A C B D |
| Annual | 9,208,598 |
| Weekday | 28,267 |
| Weekend | 37,179 |
| M3 Bus | 3 |
| Annual | 4,032,735 |
| Weekday | 12,516 |
| Weekend | 15,554 |
| Bx15 Bus | 15 |
| Annual | 6,597,695 |
| Weekday | 20,579 |
| Weekend | 24,912 |
| M101 Bus | 101 |
| Annual | 7,085,374 |
| Weekday | 22,398 |
| Weekend | 25,508 |

FLOOR PLAN - HARLEM USA

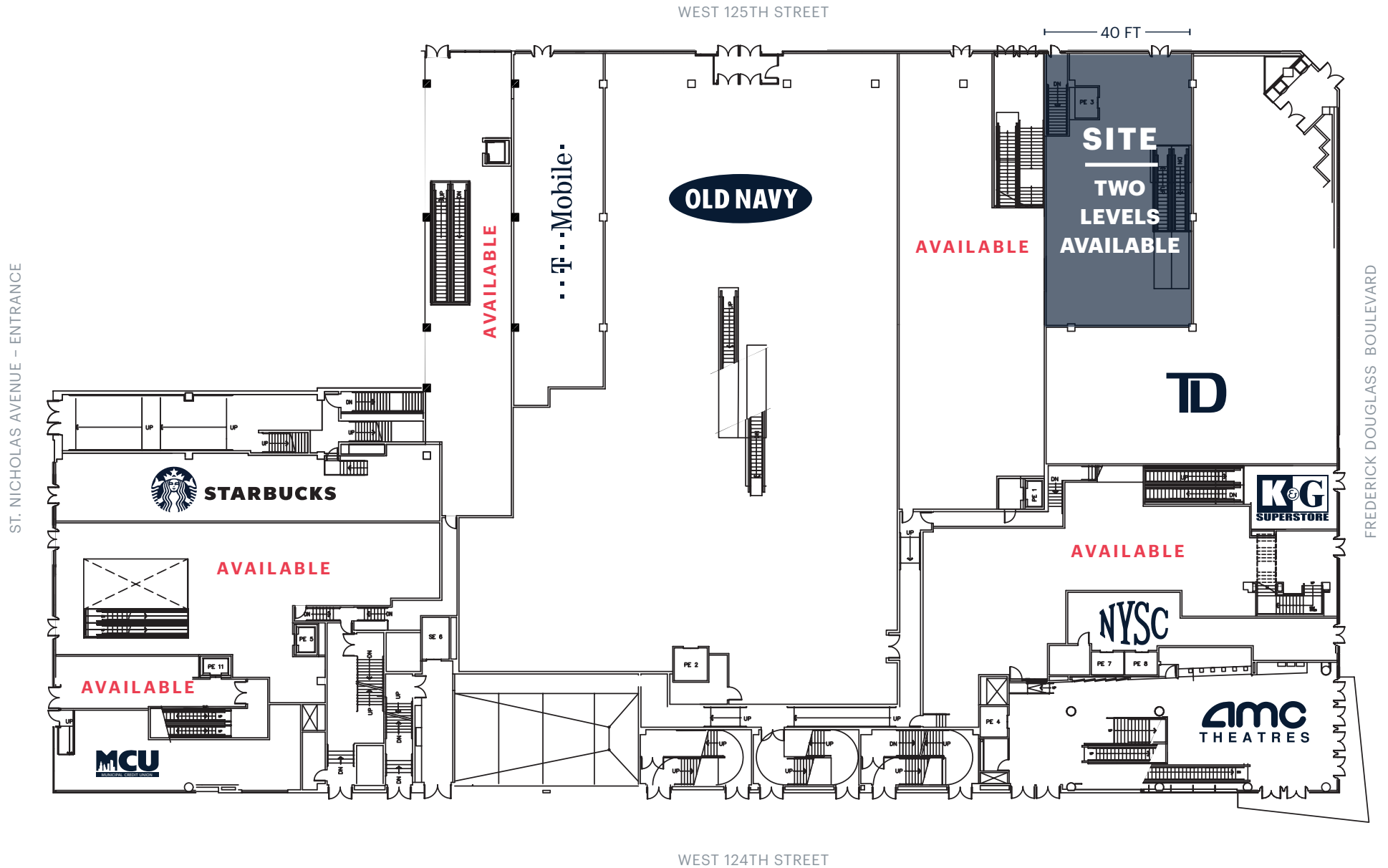

AREA RETAIL



CONTACT EXCLUSIVE AGENTS

JASON PENNINGTON
 jpennington@ripcony.com
 718.233.6565

JESSICA HEDRINGTON
 jhedrington@ripcony.com
 718.233.6565

RIPCO
 REAL ESTATE
 32 Court Street
 10th Floor
 Brooklyn, NY 11201
 718.233.6565

Please visit us at ripcony.com for more information
 This information has been secured from sources we believe to be reliable, but we make no representations as to the accuracy of the information. References to square footage are approximate. Buyer must verify the information and bears all risk for any inaccuracies.