

RETAIL/RESTAURANT SPACE

308 WEST 125TH STREET

Between Frederick Douglass Boulevard and St. Nicholas Avenue

HARLEM

NEW YORK | NY

4,280 SF

Available for Lease



RIPCO
REAL ESTATE

SPACE DETAILS

GROUND FLOOR

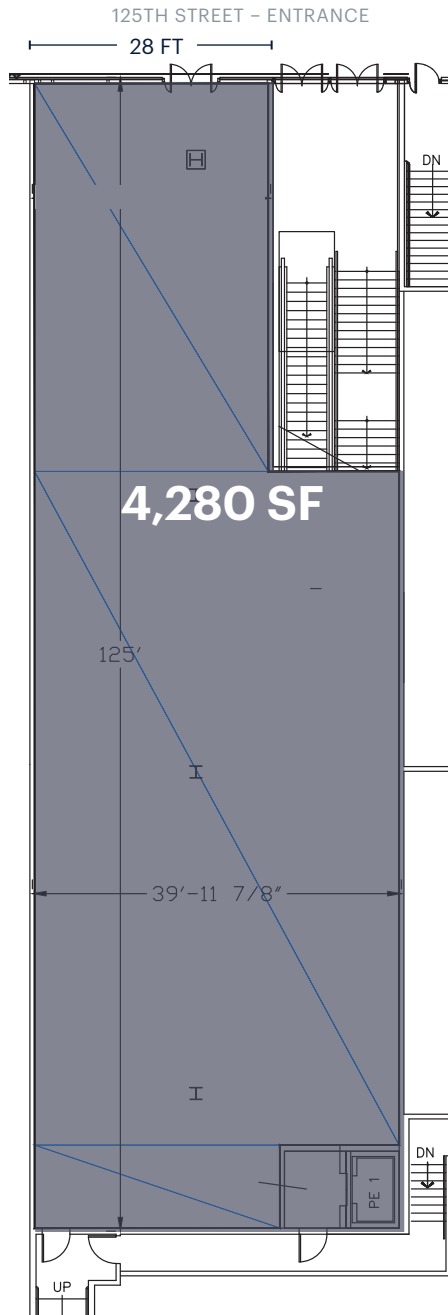

LOCATION

Located on 125th Street between Frederick Douglass Boulevard and St. Nicholas Avenue

SIZE

Ground Floor 4,280 SF

FRONTAGE

West 125th Street 28 FT

ASKING RENT

Upon Request

CURRENTLY

Vacant

POSSESSION

Arranged

NEIGHBORS

Magic Johnson Theatre, H&M, Marshalls, Starbucks, Apollo Theatre, Gap Outlet, Blink Fitness, DSW, Red Lobster, Party City, Banana Republic Factory Outlet, Old Navy, Modell's, Chuck E Cheese's, CVS, Whole Foods, Burlington Coat Factory, American Eagle, and TD Bank

COMMENTS

Second generation retail space
 Amazing signage and branding opportunity in the most recognized building on the 125th Street corridor
 Direct access to A, B, C, D subway entrances

TRANSPORTATION

2019 Ridership Report

125th Street

Annual	9,208,598
Weekday	28,267
Weekend	37,179

A C B D

M3 Bus

Annual	4,032,735
Weekday	12,516
Weekend	15,554

3

Bx15 Bus

Annual	6,597,695
Weekday	20,579
Weekend	24,912

Bx 15

M101 Bus

Annual	7,085,374
Weekday	22,398
Weekend	25,508

M 101

FLOOR PLAN - HARLEM USA

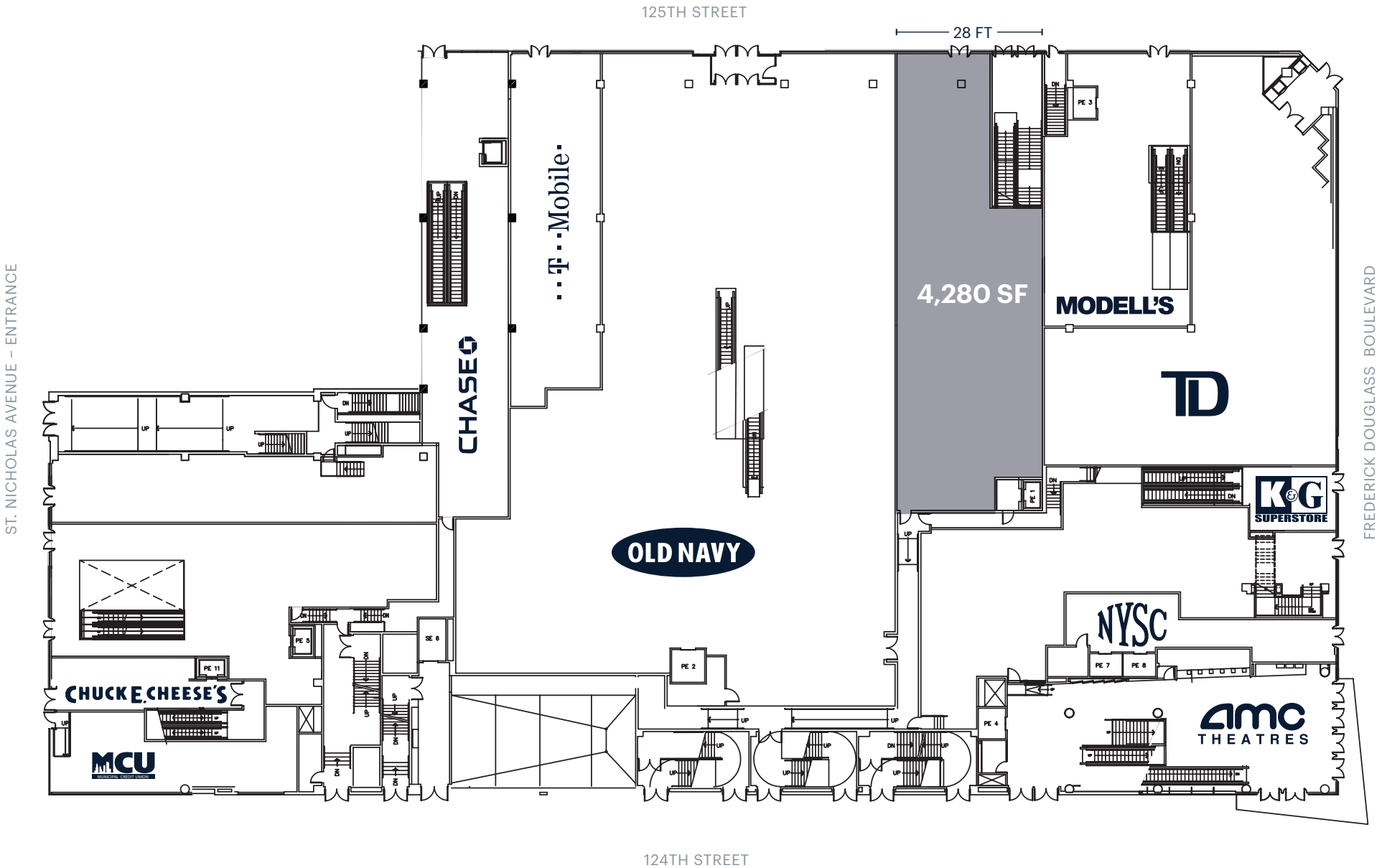

AREA RETAIL



CONTACT EXCLUSIVE AGENTS

JASON PENNINGTON

jpennington@ripcony.com
718.233.6565

JESSICA HEDRINGTON

jhedrington@ripcony.com
718.233.6565

RIPCO
REAL ESTATE

32 Court Street
10th Floor
Brooklyn, NY 11201
718.233.6565

Please visit us at ripcony.com for more information

This information has been secured from sources we believe to be reliable, but we make no representations as to the accuracy of the information. References to square footage are approximate. Buyer must verify the information and bears all risk for any inaccuracies.