

RETAIL/RESTAURANT

3123 Atlantic Avenue
Brooklyn, NY
Cypress Hills

15,400 SF
Available for Lease



Size

Ground Floor: 7,700 SF
Second Floor: 7,700 SF
Cellar: 12 Car Parking Lot

Asking Rent

\$41 PSF

Possession

2020

Frontage

100' on Atlantic Avenue

Neighbors

White Castle, Dunkin Donuts,
McDonald's, Wendy's, Family
Dollar, City Line Park, Mobilia
Furniture

Comments

12 Car Parking in basement of
building

Escalators will be provided

New residential building

Only opportunity for a
supermarket in this market

At the heart of Cypress Hills
Development

Transportation

2016 Ridership Report

Norwood Avenue

Annual	1,146,658
Weekday	3,613
Weekend	4,099

Bus Q24

Annual	2,685,813
Weekday	8,846
Weekend	9,483

Contact our exclusive agents:

Richard Senior

rsenior@ripcony.com
718.233.6565

Ben Weiner

bweiner@ripcony.com
718.233.6565



FLOOR PLANS

GROUND FLOOR

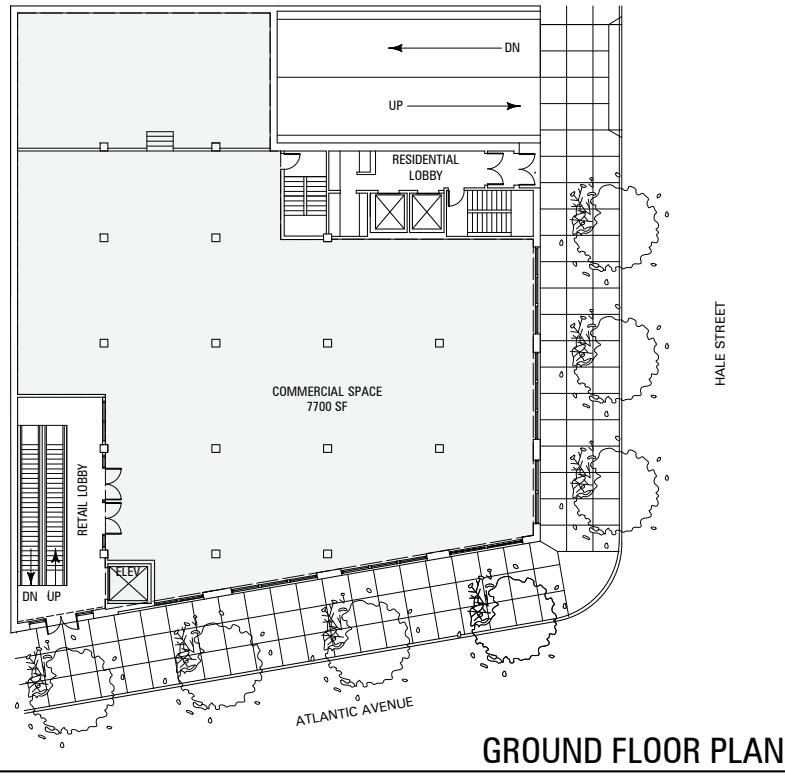

3123 ATLANTIC AVENUE

GROUND FLOOR PLAN

CWBARCHITECTS

SECOND FLOOR

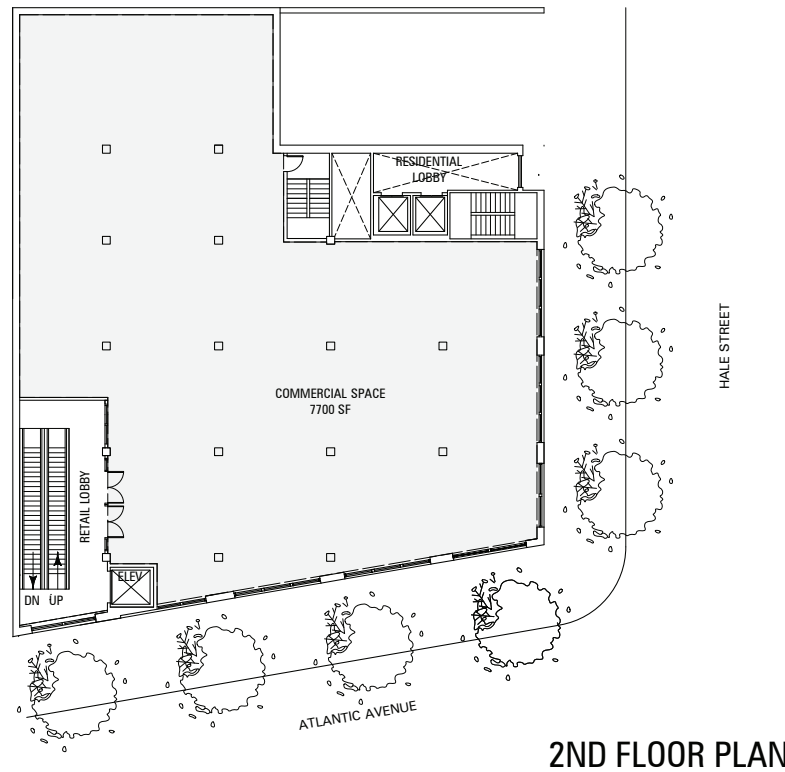

3123 ATLANTIC AVENUE

2ND FLOOR PLAN

CWBARCHITECTS

Manhattan

150 East 58th Street
15th Floor
New York, NY 10155
T. 212.750.6565

Long Island

100 Jericho Quadrangle
Suite 120
Jericho, NY 11753
T. 516.933.8880

brooklyn

32 Court Street
10th Floor
Brooklyn, NY 11201
T. 718.233.6565

New Jersey

125 Chubb Avenue
Suite 150 S
Lyndhurst, NJ 07071
T. 201.777.2300

ripcony.com

*All information is from sources deemed reliable and is submitted subject to errors, omissions, change of price, terms, rental prior to sale and withdrawal notices.